

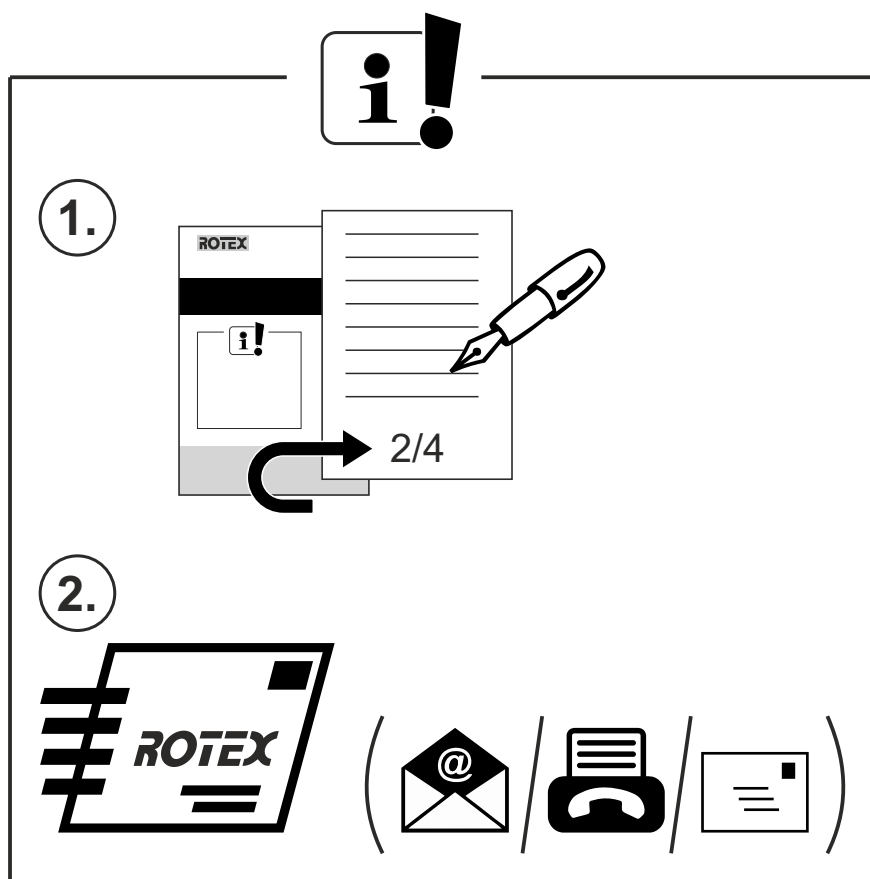

a member of **DAIKIN** group

## ROTEX HPSU/HPU Installation and instruction certificate



Installation and  
instruction certificate  
ROTEX HPSU/HPU

English



**ROTEX products distributed in UK:**  
DAIKIN AIR CONDITIONING UK Ltd.  
The Heights, Brooklands, Weybridge  
KT13 0NY Surrey  
Fon +44 845 641 90 00  
Fax +44 845 641 90 09  
[www.daikin.co.uk](http://www.daikin.co.uk)

**ROTEX Heating Systems GmbH**  
Langwiesenstraße 10  
D-74363 Güglingen  
[www.rotex-heating.com](http://www.rotex-heating.com)

### External unit data ROTEX HPSU/HPU (type plate\*)

Model/Type \_\_\_\_\_ Manufacturer's No. \_\_\_\_\_  
(under ROTEX logo) (MFG-No.)

### Internal unit data <sup>1)</sup>

#### ROTEX HPSU (compact) / HPU (type plate\*)

Model/Type \_\_\_\_\_ Manufacturer's No. \_\_\_\_\_  
(under ROTEX logo) (MFG-No.)

### Buyer

Name \_\_\_\_\_  
Street \_\_\_\_\_  
Zip code \_\_\_\_\_ Town \_\_\_\_\_  
Phone \_\_\_\_\_

**I have been instructed in the operation. I have been handed the operating instruction manual and the operating logbook.**

*Customer signature*

**ROTEX recommends that, for the operational security of your heating system, you take out a maintenance contract, and that the maintenance work carried out and the measured values determined be recorded in the operational logbook.**

**The system situation existing at commissioning and the set values should please be entered in the following tables.**

### Installation company

Name \_\_\_\_\_  
Street \_\_\_\_\_  
Zip code \_\_\_\_\_ Town \_\_\_\_\_  
Phone \_\_\_\_\_

**The listed unit was installed properly by us on the \_\_\_\_\_ and then handed over to the customer.**

*Stamp and signature of installation company*

### Commissioning company

Name \_\_\_\_\_  
Street \_\_\_\_\_  
Zip code \_\_\_\_\_ Town \_\_\_\_\_  
Phone \_\_\_\_\_

**The listed unit was commissioned properly by us on the \_\_\_\_\_ and then handed over to the customer.**

*Stamp and signature of commissioning company*

### Type of system

Heating only  Heating+cooling <sup>3)</sup>  Hot water generation

### Cooling circuit

Outdoor unit  higher  lower than internal unit  
Height difference internal/external unit \_\_\_\_\_ m  
Pipe length internal/external unit \_\_\_\_\_ m  
Number of oil pump bends \_\_\_\_\_ in number  
Soldered under nitrogen  yes  no  
Pipes thermally insulated  yes  no  
Leak testing  yes  no  
Test pressure \_\_\_\_\_ bar  
Test time \_\_\_\_\_ h  
Test medium \_\_\_\_\_  
Evacuation time \_\_\_\_\_ h  
Coolant fill volume R410A \_\_\_\_\_ kg (total)  
Fill volume entered on label  yes  no

### External unit installation

Wind protection present  yes  no  
External unit >30 cm above floor level  yes  no  
Condensate can flow away freely  yes  no  
External unit installed horizontally  yes  no  
Vibration damper installed  yes  no

### Internal unit installation

Condensate trough installed (for heating + cooling) <sup>1)2)3)</sup>  yes  no  
Condensate drain present <sup>1)3)</sup>  yes  no  
Auxiliary heating bled  yes  no  
Controller set  yes  no  
Timer function set  yes  no  
(\*fill out additional sheet!)  
Room size <sup>1)4)</sup> \_\_\_\_\_ m<sup>3</sup>

### Other components

Room thermostat (cable)  yes  no  
Wireless room thermostat  yes  no  
Room controller RoCon U1  yes  no  
ROTEX Solaris installed (\*fill out additional sheet!)  yes  no  
Sol-Pac installed  yes  no  
Overflow valve fitted <sup>2)</sup>  yes  no  
Booster heater installed <sup>2)</sup>  yes  no  
Backup heater installed  yes  no  
Return temperature limiter (RLB) installed <sup>2)3)8)</sup>  yes  no

### Documentation

Confirmation of insulation protection measures carried out is present <sup>5)</sup>  yes  no  
Handover of documentation to operator <sup>6)</sup>  yes  no  
Instruction operator/personnel <sup>7)</sup>  yes  no

### Other comments

\* Location see Installation manual  
1)2)3)4)5)6)7)8) Explanations see reverse.



## ROTEX Heating Systems GmbH accepts

the guarantee with respect to the end customer with reference to material and manufacturing faults in accordance with the guarantee conditions (see below). There will only be a valid guarantee liability if the equipment has been installed and commissioned by an expert company, and if this form has been completed in full and returned to the sales partner quoted below. Please have this confirmed by your installation company in writing on this instruction certificate.

**ROTEX recommends that, for regular care and maintenance of the unit, you take out a maintenance contract, and that the maintenance work carried out and the measured values determined be recorded in the maintenance log.**

### Explanations

- 1) Not on HPSU monobloc compact
- 2) Not on HPSU compact and not on HPSU/HPU <sup>hitemp</sup>
- 3) Not on HPSU/HPU <sup>hitemp</sup>
- 4) The room in which the internal unit is installed must have a minimum volume.  
This can be calculated using the following formula: Min. room volume in m<sup>3</sup> = total R410A fill quantity in kg / 0.3 kg/m<sup>3</sup>
- 5) An insulation protection measurement for the electrical connection must be carried out during commissioning.  
This must be carried out by a specialist electrician and must be documented accordingly.
- 6) The documentation consists of:
  - Operating instruction manual / usage instructions
  - Operating manual
- 7) Has the operator been informed of the documentation obligation concerning annual maintenance and certification of refrigerant fill quantities in accordance with F-Gas Directive (EU) No. 842/2006.
- 8) Only required when using solar or bivalent systems.

### Data protection clause

All the signatories and receivers of this form commit not handing the personal details contained therein to third parties without specific agreement.

### Guarantee conditions

The legal guarantee conditions fundamentally apply. Our warranty conditions beyond that can be found online on your sales representative's webpage.

### Copy

Original:	--> ROTEX	<input type="checkbox"/>
1st. Copy:	--> customer	<input type="checkbox"/>
2nd. Copy:	--> installation company	<input type="checkbox"/>



a member of **DAIKIN** group

[www.rotex-heating.com](http://www.rotex-heating.com)