

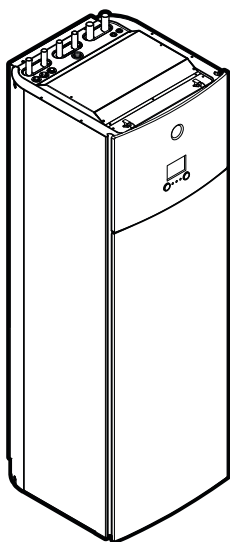

Installation manual

Daikin Altherma 3 GEO



EGSAH06DA9W
EGSAH10DA9W

EGSAX06DA9W(G)
EGSAX10DA9W(G)

Installation manual
Daikin Altherma 3 GEO

English

Table of contents

1	About the documentation	4
1.1	About this document.....	4
2	About the box	5
2.1	Indoor unit	5
2.1.1	To remove the accessories from the indoor unit.....	5
2.1.2	To handle the indoor unit	5
3	Unit installation	5
3.1	Preparing the installation site	5
3.1.1	Installation site requirements of the indoor unit	5
3.2	Opening and closing the unit.....	6
3.2.1	To open the indoor unit	6
3.2.2	To remove the hydro module from the unit.....	7
3.2.3	To close the indoor unit.....	8
3.3	Mounting the indoor unit.....	8
3.3.1	To install the indoor unit.....	8
3.3.2	To connect the drain hose to the drain	9
4	Piping installation	9
4.1	Preparing piping	9
4.1.1	To check the water volume and flow rate of the space heating circuit and brine circuit.....	9
4.2	Connecting the brine piping.....	9
4.2.1	To connect the brine piping.....	9
4.2.2	To connect the brine level vessel.....	10
4.2.3	To connect the brine filling kit	10
4.2.4	To fill the brine circuit	10
4.2.5	To insulate the brine piping	10
4.3	Connecting the water piping	10
4.3.1	To connect the water piping.....	10
4.3.2	To connect the recirculation piping	11
4.3.3	To fill the space heating circuit.....	11
4.3.4	To fill the domestic hot water tank	11
4.3.5	To insulate the water piping	11
5	Electrical installation	11
5.1	About electrical compliance.....	11
5.2	Overview of electrical connections for external and internal actuators.....	12
5.3	To connect the main power supply.....	13
5.4	To connect the remote outdoor sensor	15
5.5	To connect the shut-off valve	15
5.6	To connect the electricity meters.....	16
5.7	To connect the domestic hot water pump	16
5.8	To connect the alarm output.....	16
5.9	To connect the space cooling/heating ON/OFF output	17
5.10	To connect the changeover to external heat source	18
5.11	To connect the power consumption digital inputs	18
5.12	To connect the safety thermostat (normal closed contact).....	19
5.13	To connect the brine low pressure switch	19
5.14	LAN adapter	20
5.14.1	About the LAN adapter	20
5.14.2	Overview of electrical connections.....	21
5.14.3	Router	21
5.14.4	Electricity meter	22
5.14.5	Solar inverter/energy management system	22
6	Configuration	23
6.1	Overview: Configuration	23
6.1.1	To access the most used commands	24
6.2	Configuration wizard.....	24
6.2.1	Configuration wizard: Language	24
6.2.2	Configuration wizard: Time and date	24
6.2.3	Configuration wizard: System	24
6.2.4	Configuration wizard: Backup heater	26

6.2.5	Configuration wizard: Main zone.....	26
6.2.6	Configuration wizard: Additional zone.....	26
6.2.7	Detailed screen with weather-dependent curve.....	27
6.2.8	Configuration wizard: Tank	28
6.3	Settings menu	28
6.3.1	Main zone	28
6.3.2	Additional zone	28
6.3.3	Information	28
6.3.4	Brine.....	29
6.4	Menu structure: Overview installer settings.....	30
7	Commissioning	31
7.1	Checklist before commissioning.....	31
7.2	Checklist during commissioning.....	31
7.2.1	To perform an air purge on the water circuit.....	31
7.2.2	To perform an air purge on the brine circuit.....	32
7.2.3	To perform an operation test run	32
7.2.4	To perform an actuator test run	32
7.2.5	To perform an underfloor heating screed dryout.....	32
7.2.6	To start or stop 10-day brine pump operation.....	33
8	Hand-over to the user	33
9	Technical data	34
9.1	Piping diagram: Indoor unit	34
9.2	Wiring diagram: Indoor unit	35

1 About the documentation

1.1 About this document

Target audience

Authorised installers

Documentation set

This document is part of a documentation set. The complete set consists of:

- **General safety precautions:**
 - Safety instructions that you must read before installing
 - Format: Paper (in the box of the unit)
- **Operation manual:**
 - Quick guide for basic usage
 - Format: Paper (in the box of the unit)
- **User reference guide:**
 - Detailed step-by-step instructions and background information for basic and advanced usage
 - Format: Digital files on <http://www.daikineurope.com/support-and-manuals/product-information/>
- **Installation manual:**
 - Installation instructions
 - Format: Paper (in the box of the unit)
- **Installer reference guide:**
 - Preparation of the installation, good practices, reference data, ...
 - Format: Digital files on <http://www.daikineurope.com/support-and-manuals/product-information/>
- **Addendum book for optional equipment:**
 - Additional info about how to install optional equipment
 - Format: Paper (in the box of the unit) + Digital files on <http://www.daikineurope.com/support-and-manuals/product-information/>

Latest revisions of the supplied documentation may be available on the regional Daikin website or via your dealer.

The original documentation is written in English. All other languages are translations.

Technical engineering data

- A **subset** of the latest technical data is available on the regional Daikin website (publicly accessible).
- The **full set** of latest technical data is available on the Daikin extranet (authentication required).

Online tools

In addition to the documentation set, some online tools are available for installers.

Heating Solutions Navigator

- Digital toolbox that offers a variety of tools to facilitate the installation and configuration of heating systems.
- To access Heating Solutions Navigator, registration to the Stand By Me platform is required. For more information, see <https://professional.standbyme.daikin.eu/>.

Daikin e-Care

- Mobile app for installers and service technicians that allows you to register, configure and troubleshoot heating systems.
- The mobile app can be downloaded for iOS and Android devices using the QR codes below. Registration to the Stand By Me platform is required to access the app.

App Store



Google Play



- f O-rings (spares for hydro module shut-off valves)
- g Energy label
- h General safety precautions
- i Addendum book for optional equipment
- j Installation manual
- k Operation manual

2.1.2 To handle the indoor unit

Mind the following guidelines when handling the unit:



- The unit is heavy. At least 2 persons are needed to handle it.
- Use a trolley to transport the unit. Make sure to use a trolley with a sufficiently long horizontal ledge, suitable for transportation of heavy appliances.
- When transporting the unit, keep the unit straight.
- Use the handles at the back to carry the unit.

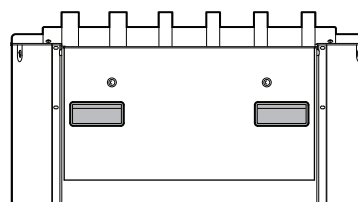

- Remove the hydro module when you want to carry the unit up or down staircases. See "3.2.2 To remove the hydro module from the unit" on page 7 for more information.
- It is recommended to use lifting straps to carry the unit up or down staircases.

2 About the box

2.1 Indoor unit

2.1.1 To remove the accessories from the indoor unit

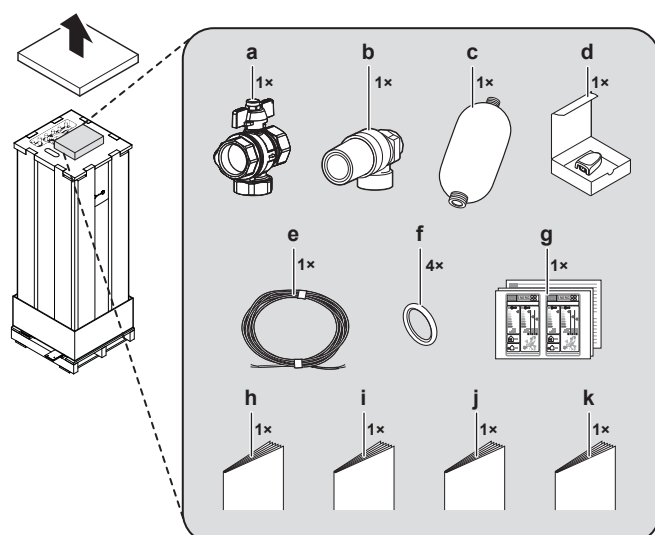

- a Shut-off valve with integrated filter
- b Safety valve (connection parts for mounting on top of brine level vessel included)
- c Brine level vessel
- d Remote outdoor sensor (with installation manual)
- e Cable for remote outdoor sensor (40 m)

3 Unit installation

3.1 Preparing the installation site

3.1.1 Installation site requirements of the indoor unit

- Mind the following spacing installation guidelines:

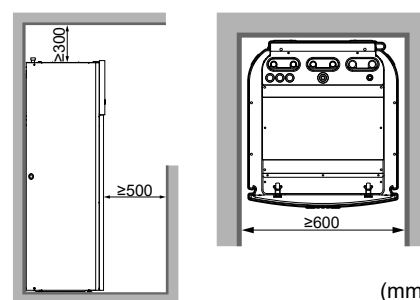

INFORMATION

If you have limited installation space and need to install the option kit EKGSPWCAB (= power cable for split power supply), remove the left side panel before installing the unit in its final position. See "3.2.1 To open the indoor unit" on page 6.

- The indoor unit is designed for indoor installation only and for ambient temperatures ranging from 5~35°C.

3 Unit installation

Special requirements for R32

The indoor unit contains an internal refrigerant circuit (R32), but you do NOT have to do any refrigerant field piping or refrigerant charging.

The total refrigerant charge in the system is ≤ 1.842 kg, so the system is NOT subjected to any requirements to the installation room. However, mind the following requirements and precautions:



WARNING

- Do NOT pierce or burn.
- Do NOT use means to accelerate the defrosting process or to clean the equipment, other than those recommended by the manufacturer.
- Be aware that R32 refrigerant does NOT contain an odour.



WARNING

The appliance shall be stored so as to prevent mechanical damage and in a well-ventilated room without continuously operating ignition sources (example: open flames, an operating gas appliance or an operating electric heater).



WARNING

Make sure installation, servicing, maintenance and repair comply with instructions from Daikin and with applicable legislation (for example national gas regulation) and are executed only by authorised persons.

3.2 Opening and closing the unit

3.2.1 To open the indoor unit



NOTICE

For a standard installation, it is usually NOT required to open the unit. Opening the unit or any of the switch boxes is ONLY required when you want to install extra option kits. For more information, see the installation manual of the specific option kit, or below.

To open the indoor unit

- 1 Remove the top panel.

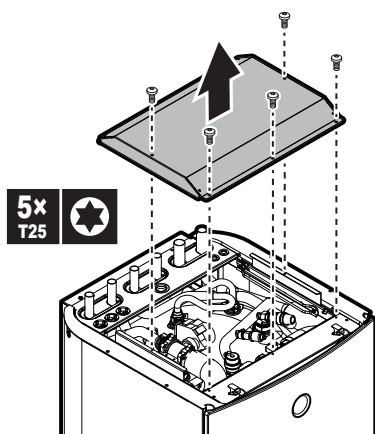

- 2 Remove the user interface panel. Open the hinges at the top and slide the top panel upwards.



NOTICE

If you remove the user interface panel, also disconnect the cables from the back of the panel to prevent damage.

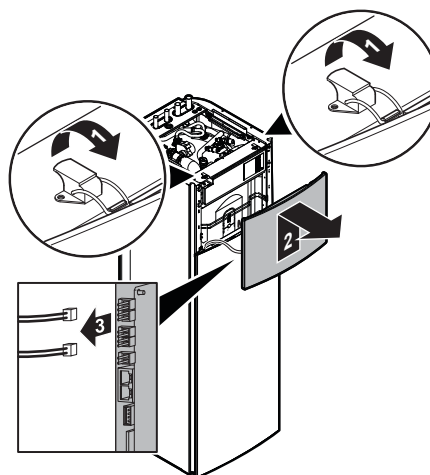

- 3 If necessary, remove the front panel. This is, for example, necessary when you want to remove the hydro module from the unit. See ["3.2.2 To remove the hydro module from the unit"](#) on [page 7](#) for more information.

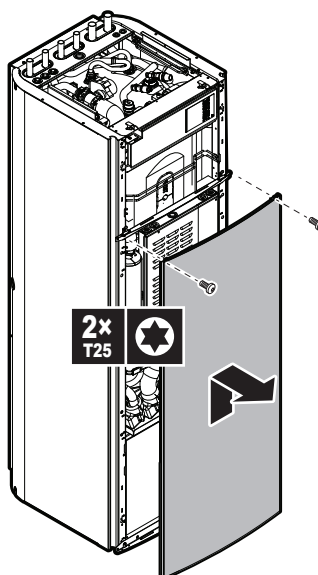

- 4 In case you want to install the option kit EKGSPOWCAB (= power cable for split power supply), also remove the left side panel. Also see ["5.3 To connect the main power supply"](#) on [page 13](#).

3.2.2 To remove the hydro module from the unit

Removing the hydro module is only required for easier transportation of the unit or for servicing. The removal of the module will significantly reduce the weight of the unit. This makes the unit easier to handle and carry.

- 1 Open the following (see "3.2.1 To open the indoor unit" on page 6):

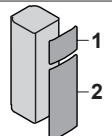
1	User interface panel	
2	Front panel	

- 2 Remove the insulation from the shut-off valves by unfixing the velcro straps on the back of the valves.

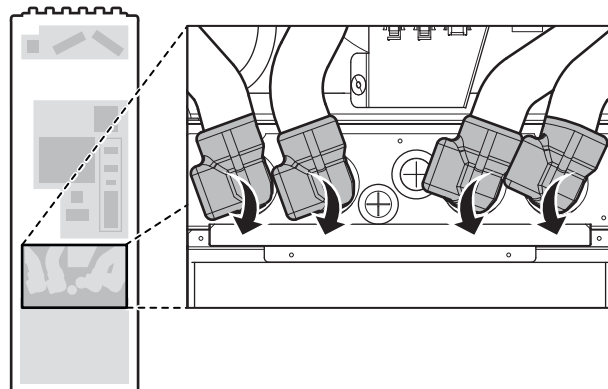

- 3 Remove the clips that lock the valves in place.

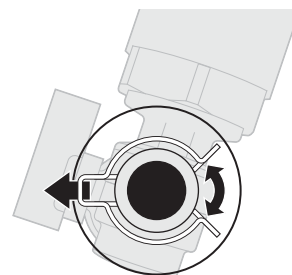

- 4 Uncouple the piping.

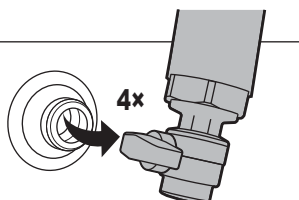

- 5 Remove the lower hydro module cover.

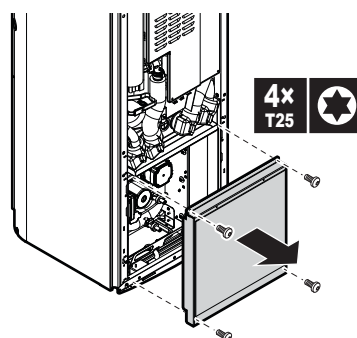

- 6 Unlink the connectors that run from the hydro module to the main switch box or other locations. Route the wires through the grommets of the upper hydro module cover.

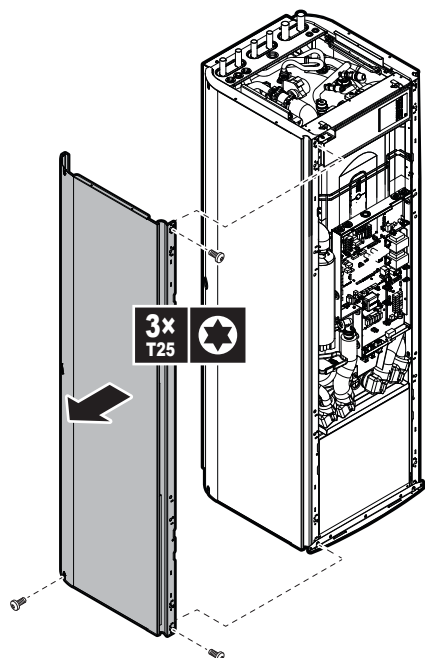

To open the switch box cover of the indoor unit

- 5 Open the installer switch box as follows:

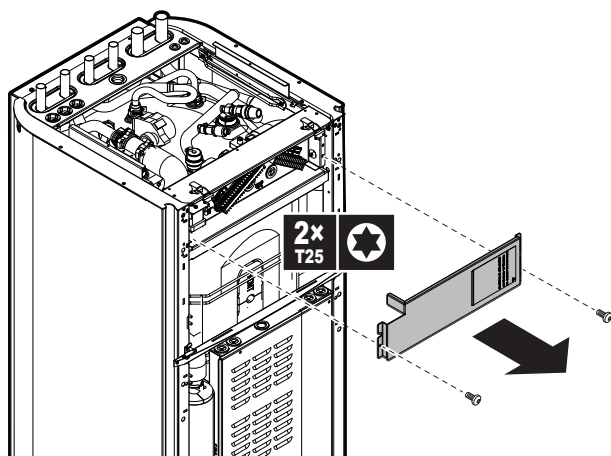

- 6 In case you have to install additional options that require access to the main switch box, remove the main switch box cover as follows:

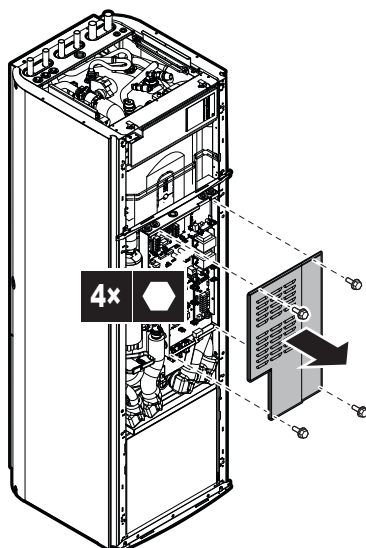

3 Unit installation

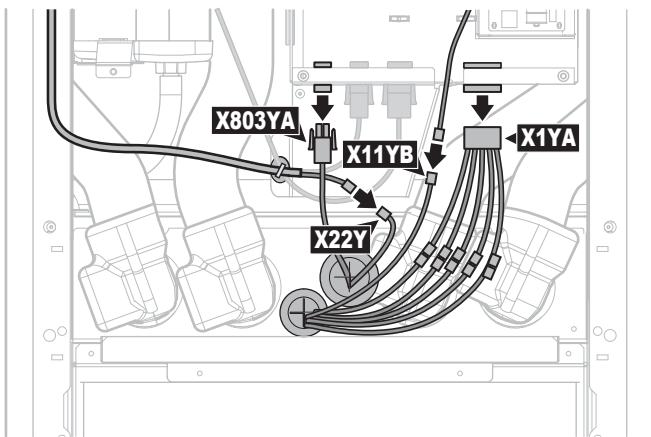

- 7 Remove the upper hydro module cover. You can lift up the uncoupled piping to access the screws more easily, and to take off the cover itself.

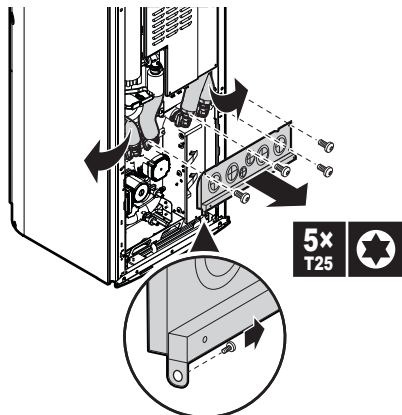

- 8 Remove the screw that fixes the hydro module to the bottom plate.

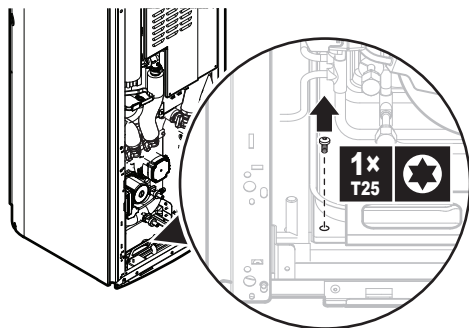

- 9 Lift up the uncoupled piping and use the handle on the front of the module to carefully slide the module out of the unit. Make sure the module remains level and does not tilt forward.

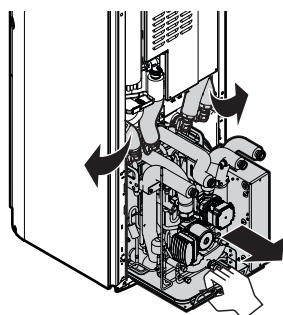

CAUTION

The hydro module is heavy. It requires at least two persons to carry it.



NOTICE

Make sure not to damage any insulation during the removal process.

Removal after first installation

If the water and brine circuits have been filled before, the procedure for removing the hydro module involves steps in addition to those described above:

- 1 Close the shut-off valves by turning the lever handles before uncoupling the piping.

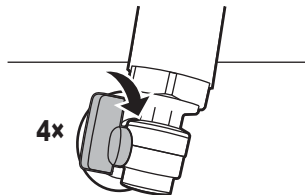

- 2 Before sliding out the module, drain remaining water and brine from the hydro module. Open the water and brine air purge valves at the top of the module to speed up the draining process.

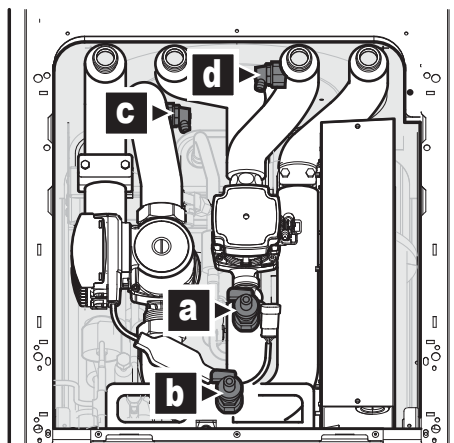

- a Water drain valve
- b Brine drain valve
- c Brine air purge valve
- d Water air purge valve

3.2.3 To close the indoor unit

- 1 If applicable, reinstall the left side panel.
- 2 If applicable, reinsert the hydro module.
- 3 If applicable, close the cover of the main switch box and reinstall the front panel.
- 4 Close the cover of the installer switch box.
- 5 Reconnect the cables to the user interface panel.
- 6 Reinstall the user interface panel.
- 7 Reinstall the top panel.



NOTICE

When closing the indoor unit cover, make sure that the tightening torque does NOT exceed 4.1 N·m.

3.3 Mounting the indoor unit

3.3.1 To install the indoor unit

- 1 Lift the indoor unit from the pallet and place it on the floor. See ["2.1.2 To handle the indoor unit" on page 5](#).
- 2 Connect the drain hose to the drain. See ["3.3.2 To connect the drain hose to the drain" on page 9](#).

- 3 Slide the unit into position.
- 4 Adjust the height of the 4 levelling feet of the outer frame to compensate for floor irregularities. The maximum allowed deviation is 1°.

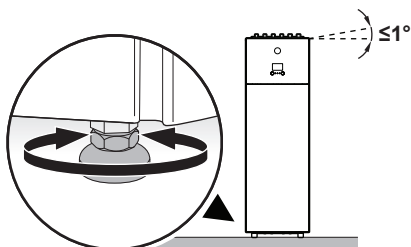

NOTICE

Do NOT tilt the unit forwards:

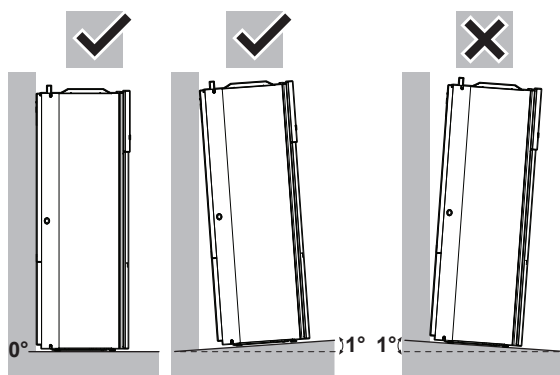

NOTICE

To avoid structural damage on unit, ONLY move the unit when levelling feet are at their lowest position.



NOTICE

For optimum sound reduction, carefully check if there is no gap between the bottom frame and the floor.

3.3.2 To connect the drain hose to the drain

Condensate can form inside the unit during cooling operation or with low brine temperatures. The top and backup heater drain pans are connected to a drain hose inside the unit. You must connect the drain hose to an appropriate drain according to the applicable legislation. The drain hose is routed through the rear panel, towards the right side of the unit.

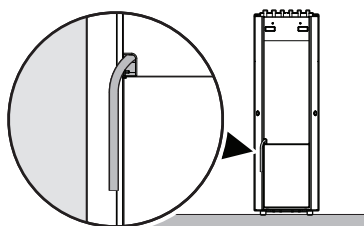

4 Piping installation

4.1 Preparing piping



NOTICE

In case of plastic pipes, make sure they are fully oxygen diffusion tight according to DIN 4726. The diffusion of oxygen into the piping can lead to excessive corrosion.



WARNING

It is the responsibility of the installer to ensure the compatibility of field piping with the used anti-freeze fluid in the brine circuit. Do NOT use Zn-coated piping, as this may lead to excessive corrosion. See also "4.2.4 To fill the brine circuit" on page 10.

4.1.1 To check the water volume and flow rate of the space heating circuit and brine circuit

Minimum water volume

Check that the total water volume per circuit in the installation is minimum 20 litre, the internal water volume of the indoor unit NOT included.



INFORMATION

If a minimum heating load of 1 kW can be guaranteed and setting [4.B] Space heating/cooling > Overshoot (overview field setting [9-04]) is 4°C, the minimum water volume can be lowered to 10 litre.



INFORMATION

In critical processes, or in rooms with a high heat load, extra water might be required.



NOTICE

When circulation in each space heating/cooling loop is controlled by remotely controlled valves, it is important that the minimum water volume is guaranteed, even if all of the valves are closed.

Minimum flow rate



NOTICE

If glycol was added to the water circuit, and the temperature of the water circuit is low, the flow rate will NOT be displayed on the user interface. In this case, the minimum flow rate can be checked by way of the pump test (check that the user interface does NOT display error 7H).

There is no minimum required flow rate.

4.2 Connecting the brine piping

4.2.1 To connect the brine piping

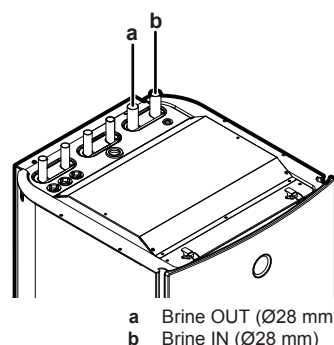

NOTICE

To facilitate service and maintenance, it is recommended to install shut-off valves as close as possible to the inlet and outlet of the unit.

4 Piping installation

4.2.2 To connect the brine level vessel

The brine level vessel (delivered as accessory) must be installed on the brine side of the heat pump system. A safety valve is included with the vessel. The vessel serves as a visual indicator of the brine level of the system. Air trapped in the system is collected by the vessel, causing the level of brine in the vessel to decrease.

- 1 Install the brine level vessel as the highest point in the brine circuit on the entering brine piping.
- 2 Mount the included safety valve on top of the vessel.
- 3 Install a shut-off valve (field supplied) below the vessel.

NOTICE

If it is not possible to install the brine level vessel as the highest point in the circuit, install an expansion vessel (field supply) and install the safety valve in front of the expansion vessel. Failure to observe this instruction may result in malfunctioning of the unit.

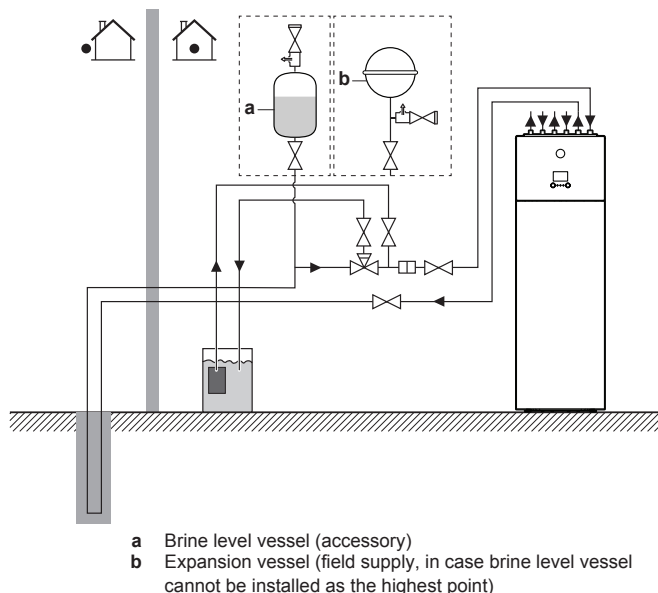

If the level of brine in the vessel is lower than 1/3, fill the vessel with brine:

- 4 Close the shut-off valve below the vessel.
- 5 Remove the safety valve on top of the vessel.
- 6 Top up the vessel with brine until it is approximately 2/3 filled.
- 7 Reconnect the safety valve.
- 8 Open the shut-off valve below the vessel.

4.2.3 To connect the brine filling kit

A brine filling kit (field supply or option kit KGSFILL2) can be used to flush, fill and drain the brine circuit of the system.

For installation instructions, see the installation manual of the brine filling kit.

4.2.4 To fill the brine circuit



WARNING

Before, during and after filling carefully check the brine circuit for leakage.



INFORMATION

The materials used in the brine circuit of the unit are chemically resistant to the following anti-freeze fluids:

- 40 mass% propylene glycol
- 29 mass% ethanol

- 1 Install the brine filling kit. See "4.2.3 To connect the brine filling kit" on page 10.
- 2 Connect a field supplied brine filling system to the 3-way valve.
- 3 Position the 3-way valve correctly.

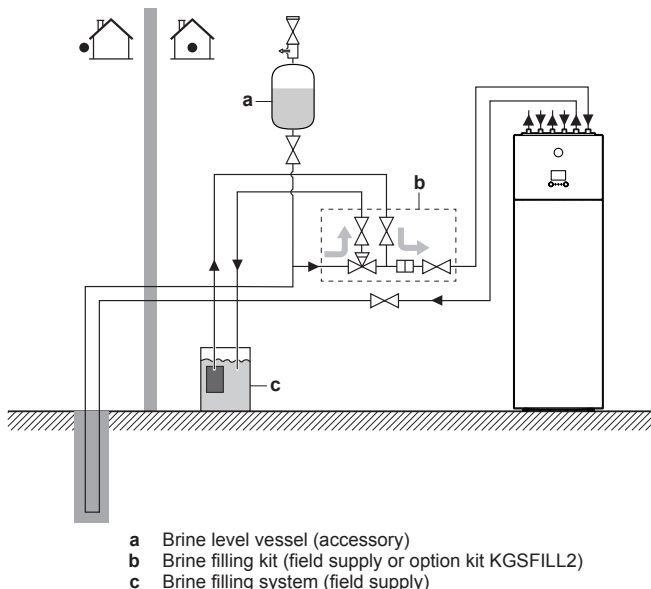

- 4 Fill the circuit with brine until a pressure of ± 2.0 bar (= 200 kPa).
- 5 Return the 3-way valve to its original position.



NOTICE

A field supplied filling kit may come without a filter that protects components in the brine circuit. In this case, it is the responsibility of the installer to install a filter on the brine side of the system.



WARNING

Temperature of the fluid running through the evaporator can become negative. It MUST be protected against freezing. For more information, see setting [A-04] in "6.3.4 Brine" on page 29.

4.2.5 To insulate the brine piping

The piping in the complete brine circuit MUST be insulated to prevent reduction of the heating capacity.

Consider that the brine circuit piping inside the house can/will condensate. Foresee adequate insulation for these pipes.

4.3 Connecting the water piping

4.3.1 To connect the water piping



NOTICE

Do NOT use excessive force when connecting the piping. Deformation of the piping can cause malfunctioning of the unit.

- 1 Install the shut off-valve with integrated filter (delivered as accessory) at the space heating/cooling water inlet.
- 2 Connect the space heating/cooling in pipe to the shut-off valve and the space heating/cooling out pipe to the unit.

- 3 Connect the domestic hot water in and out pipes to the indoor unit.

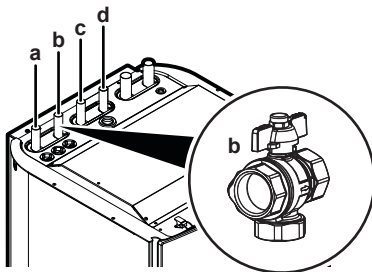

- a Space heating/cooling water OUT (Ø22 mm)
- b Space heating/cooling water IN (Ø22 mm) and shut-off valve with integrated filter (accessory)
- c Domestic hot water: hot water OUT (Ø22 mm)
- d Domestic hot water: cold water IN (Ø22 mm)



NOTICE

It is recommended to install shut-off valves to cold water in and hot water out connections. Shut-off valves are field supplied.



NOTICE

About the shut-off valve with integrated filter (delivered as accessory):

- The installation of the valve at the water inlet is mandatory.
- Mind the flow direction of the valve



NOTICE

Install air purge valves at all local high points.



NOTICE

A pressure relief valve (field supply) with an opening pressure of maximum 10 bar (= 1 MPa) must be installed on the domestic cold water inlet connection in accordance with the applicable legislation.

4.3.2 To connect the recirculation piping

Prerequisite: Only required if you need recirculation in your system.

- 1 Remove the top panel from the unit, see "3.2.1 To open the indoor unit" on page 6.
- 2 Cut out the rubber grommet on top of the unit, and remove the stop. The recirculation connector is located below the space heating/cooling water outlet pipe.
- 3 Route the recirculation piping through the grommet and connect it to the recirculation connector.

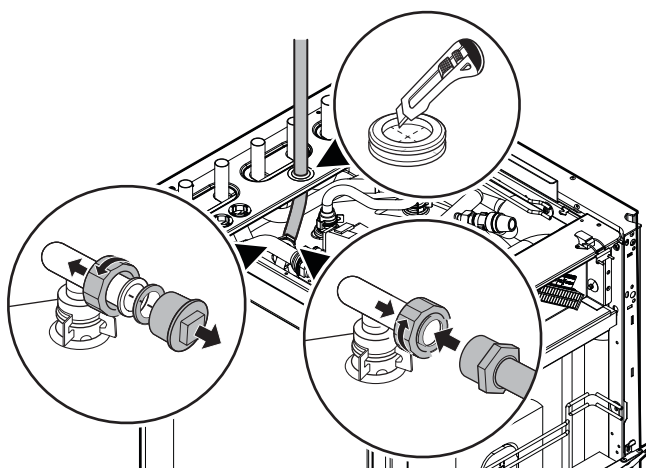

- 4 Reattach the top panel.

4.3.3 To fill the space heating circuit

To fill the space heating circuit, use a field supply filling kit. Make sure you comply with the applicable legislation.



NOTICE

- Air in the water circuit can cause malfunctioning of the backup heater. During filling, it may not be possible to remove all the air from the circuit. Remaining air will be removed through the automatic air purge valves during the initial operating hours of the system. Additional filling with water afterwards may be required.
- To purge the system, use the special function as described in the chapter "7 Commissioning" on page 31. This function should be used to purge the heat exchanger coil of the domestic hot water tank.

4.3.4 To fill the domestic hot water tank

- 1 Open every hot water tap in turn to purge air from the system pipe work.
- 2 Open the cold water supply valve.
- 3 Close all water taps after all air is purged.
- 4 Check for water leaks.
- 5 Manually operate the field-installed pressure relief valve to ensure a free water flow through the discharge pipe.

4.3.5 To insulate the water piping

The piping in the complete water circuit **MUST** be insulated to prevent reduction of the heating capacity.

Consider that the space heating piping can condensate during cooling operation. Foresee adequate insulation for these pipes.

5 Electrical installation



DANGER: RISK OF ELECTROCUTION



WARNING

ALWAYS use multicore cable for power supply cables.



CAUTION

Do NOT push or place redundant cable length in the unit.



NOTICE

The distance between the high voltage and low voltage cables should be at least 50 mm.

5.1 About electrical compliance

For the models EGSAH/X06+10DA9W(G), the following statement...

Equipment complying with EN/IEC 61000-3-12 (European/ International Technical Standard setting the limits for harmonic currents produced by equipment connected to public low-voltage systems with input current >16 A and ≤75 A per phase.).

...is valid in the following cases:



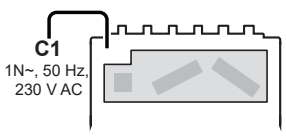
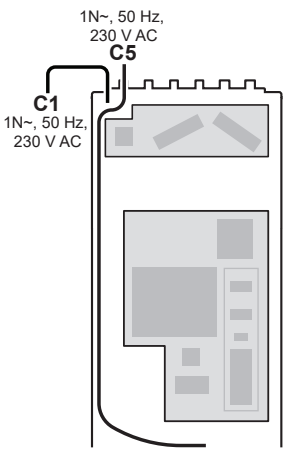









5 Electrical installation





#	Power supply ^(a)	Operation ^(b)
1	Combined power supply (1N~, 50 Hz, 230 V AC) 	Normal or emergency
2	Split power supply (2×(1N~, 50 Hz, 230 V AC)) 	Emergency

- (a) For details of C1 and C5, see ["5.3 To connect the main power supply"](#) on page 13.
- (b) **Normal operation:** backup heater = maximum 3 kW
Emergency operation: backup heater = maximum 6 kW

5.2 Overview of electrical connections for external and internal actuators

Item	Description
Power supply	See "5.3 To connect the main power supply" on page 13.
Remote outdoor sensor	See "5.4 To connect the remote outdoor sensor" on page 15.
Shut-off valve	See "5.5 To connect the shut-off valve" on page 15.
Electricity meter	See "5.6 To connect the electricity meters" on page 16.
Domestic hot water pump	See "5.7 To connect the domestic hot water pump" on page 16.
Alarm output	See "5.8 To connect the alarm output" on page 16.
Space cooling/heating operation control	See "5.9 To connect the space cooling/heating ON/OFF output" on page 17.
Changeover to external heat source control	See "5.10 To connect the changeover to external heat source" on page 18.
Power consumption digital inputs	See "5.11 To connect the power consumption digital inputs" on page 18.
Safety thermostat	See "5.12 To connect the safety thermostat (normal closed contact)" on page 19.
Brine low pressure switch	See "5.13 To connect the brine low pressure switch" on page 19.
LAN adapter connections	See "5.14 LAN adapter" on page 20.

Item	Description
Room thermostat (wired or wireless)	 See: <ul style="list-style-type: none"> Installation manual of the room thermostat (wired or wireless) Addendum book for optional equipment
	 Wires for wired room thermostat: (3 for cooling/heating operation; 2 for heating only operation)×0.75 mm ² Wires for wireless room thermostat: (5 for cooling/heating operation; 4 for heating only operation)×0.75 mm ² Maximum running current: 100 mA
	 For the main zone: <ul style="list-style-type: none"> [2.9] Control1 [2.A] Thermostat type For the additional zone: <ul style="list-style-type: none"> [3.A] Thermostat type [3.9] (read-only) Control1
Heat pump convector	 See: <ul style="list-style-type: none"> Installation manual of the heat pump convectors Addendum book for optional equipment
	 Wires: 4×0.75 mm ² Maximum running current: 100 mA
	 For the main zone: <ul style="list-style-type: none"> [2.9] Control1 [2.A] Thermostat type For the additional zone: <ul style="list-style-type: none"> [3.A] Thermostat type [3.9] (read-only) Control1
Remote indoor sensor	 See: <ul style="list-style-type: none"> Installation manual of the remote indoor sensor Addendum book for optional equipment
	 Wires: 2×0.75 mm ²
	 [9.B.1]=2 (External sensor = Room) [1.7] Room sensor offset
Current sensors	 See the installation manual of the current sensors.
	 Wires: 3×2. Use part of the cable (40 m) delivered as accessory.
	 [9.9.1]=3 (Power consumption control1 = Current sensor) [9.9.E] Current sensor offset

Item	Description
Human Comfort Interface	 See: <ul style="list-style-type: none"> Installation and operation manual of the Human Comfort Interface Addendum book for optional equipment
	 Wires: 2×(0.75~1.25 mm ²) Maximum length: 500 m
	 [2.9] Control  [1.6] Room sensor offset

5.3 To connect the main power supply

Use one of the following layouts to connect the power supply (for details of C1~C5, see below the table):

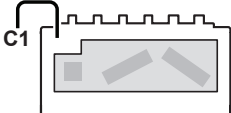
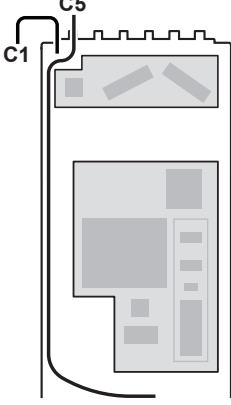
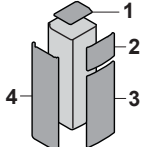
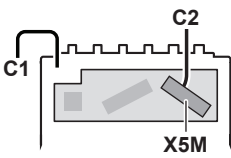
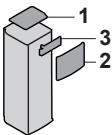
#	Layout	Open the unit ^(a)
1	<p>Single cable power supply (= combined power supply)</p>  <p>C1: Power supply for the backup heater, and the rest of the unit (3N~ or 1N~)</p>	Not necessary (connection to factory-mounted cable outside of the unit)
2	<p>Dual cable power supply (= split power supply)</p> <p>Note: This is for example needed for installations in Germany.</p>  <p>C1: Power supply for the backup heater (3N~ or 1N~) C5: Power supply for the rest of the unit (1N~)</p>	
3	<p>Preferential kWh rate power supply without separate normal kWh rate power supply^(b)</p>  <p>C1: Preferential kWh rate power supply (3N~ or 1N~) C2: Preferential kWh rate power supply contact</p>	

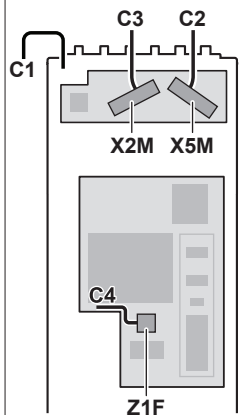
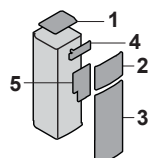
#	Layout	Open the unit ^(a)
4	<p>Preferential kWh rate power supply with separate normal kWh rate power supply^(b)</p>  <p>C1: Preferential kWh rate power supply (3N~ or 1N~) C2: Preferential kWh rate power supply contact C3: Separate normal kWh rate power supply (1N~) C4: Connection of X11Y</p>	

- (a) See "3.2.1 To open the indoor unit" on page 6.
(b) Types of preferential kWh rate power supply:



INFORMATION

Some types of preferential kWh rate power supply require a separate normal kWh rate power supply to the indoor unit. This is required in the following cases:

- if the preferential kWh rate power supply is interrupted when active, OR
- if no power consumption of the indoor unit is allowed at the preferential kWh rate power supply when active.

Detail C1: Factory-mounted power supply cable



Wires: 3N+GND, OR 1N+GND

Maximum running current: Refer to name plate on unit.

Connect the factory-mounted power supply cable to a 1N~ or 3N~ power supply.

5 Electrical installation

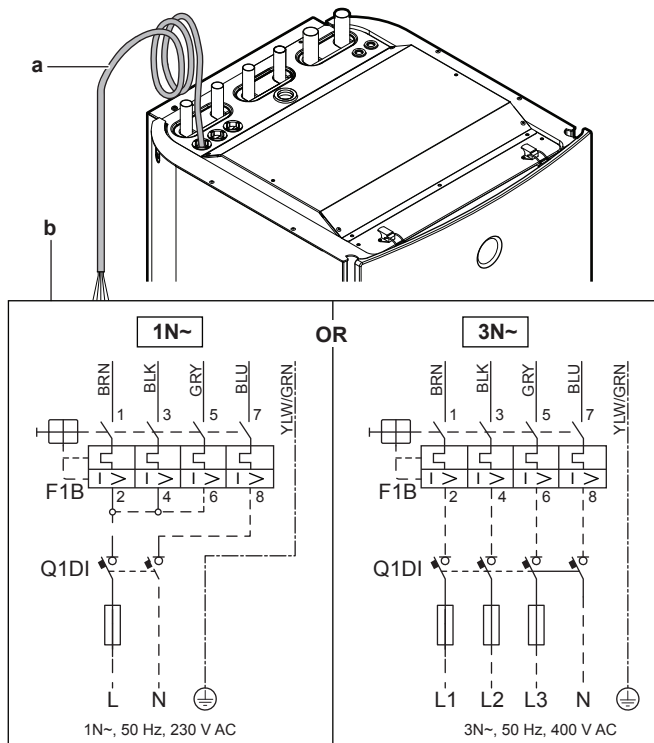

- a Factory-mounted power supply cable
b Field wiring
F1B Overcurrent fuse (field supply). Recommended fuse for 1N~: 4-pole, 32 A fuse, C curve. Recommended fuse for 3N~: 4-pole, 16 A fuse, C curve.
Q1DI Earth leakage circuit breaker (field supply)

Detail C2: Preferential kWh rate power supply contact

Wires: 2×(0.75~1.25 mm²)
Maximum length: 50 m.
Preferential kWh rate power supply contact: 16 V DC detection (voltage supplied by PCB). The voltage-free contact shall ensure the minimum applicable load of 15 V DC, 10 mA.

Connect the preferential kWh rate power supply contact (S1S) as follows.

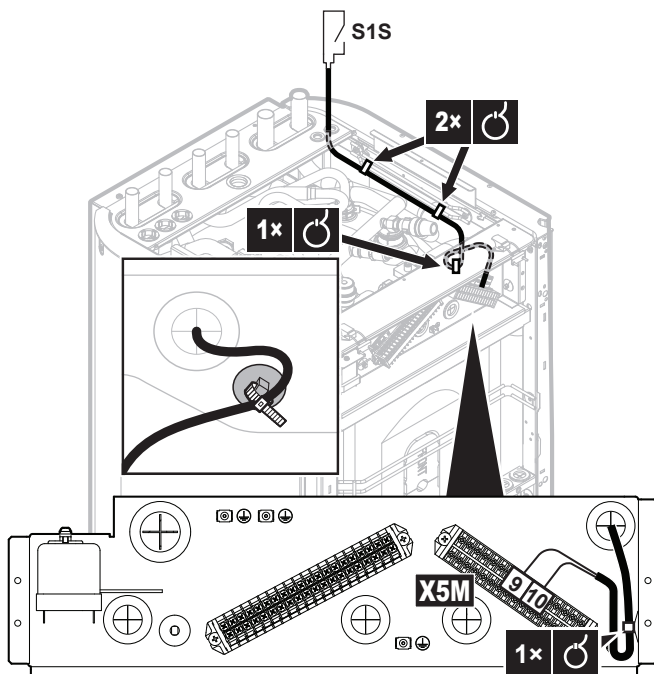

INFORMATION

The preferential kWh rate power supply contact is connected to the same terminals (X5M/9+10) as the safety thermostat. It is only possible for the system to have EITHER preferential kWh rate power supply OR a safety thermostat.

Detail C3: Separate normal kWh rate power supply

Wires: 1N+GND
Maximum running current: 6.3 A

Connect the separate normal kWh rate power supply as follows:

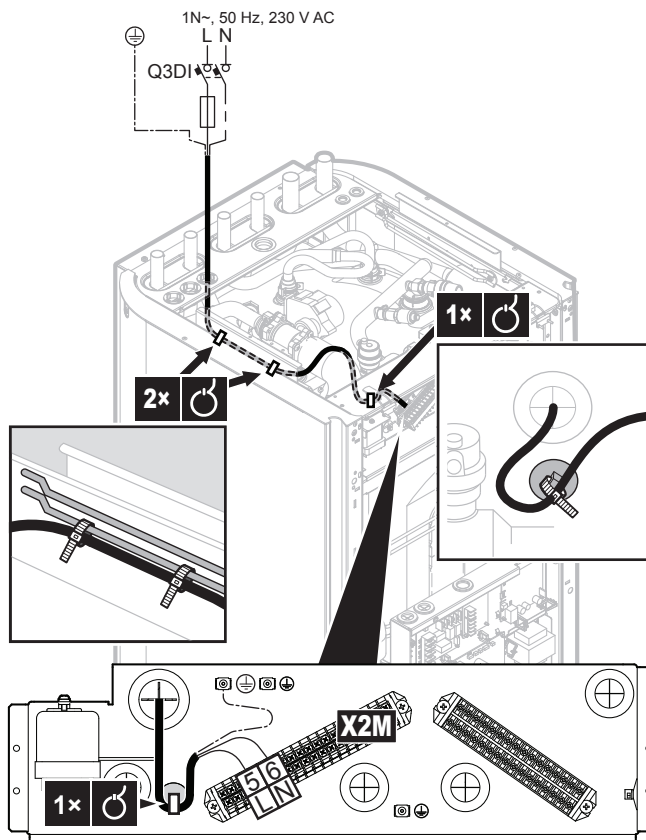

Detail C4: Connection of X11Y

Factory-mounted cables.

Disconnect X11Y from X11YA, and connect it to X11YB.

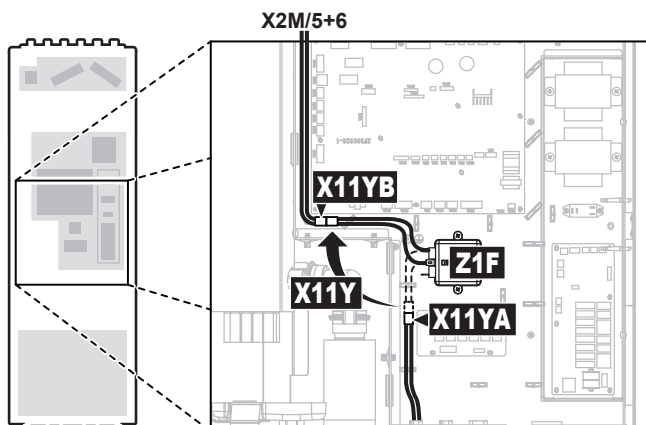

Detail C5: Option kit EKGSPOWCAB

 Install the option kit EKGSPOWCAB (= power cable for split power supply). For installation instructions, see the installation manual of the option kit.

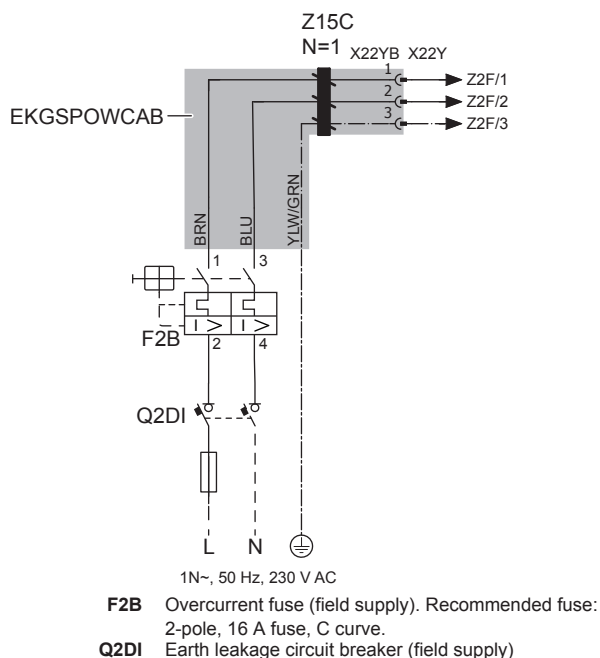

Configuration power supply

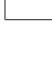

-  [9.3] Backup heater
-  [9.8] Benefit kWh power supply

5.4 To connect the remote outdoor sensor

The remote outdoor sensor (delivered as accessory) measures the outdoor ambient temperature.

INFORMATION

If the desired leaving water temperature is weather dependent, the full time outdoor temperature measurement is important.

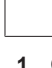
-  Remote outdoor sensor + cable (40 m) delivered as accessory
-  [9.B.2] Ext. amb. sensor offset (= overview field setting [2-0B])
-  [9.B.3] Averaging time (= overview field setting [1-0A])

- 1 Connect the external temperature sensor cable to the indoor unit.

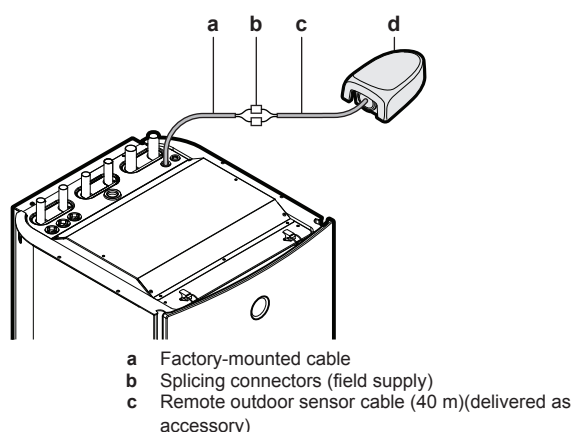



- d Remote outdoor sensor (delivered as accessory)

- 2 Fix the cable with cable ties to the cable tie mountings.
- 3 Install the remote outdoor sensor outside as described in the installation manual of the sensor (delivered as accessory).

5.5 To connect the shut-off valve

INFORMATION

Shut-off valve usage example. In case of one LWT zone, and a combination of under floor heating and heat pump convectors, install a shut-off valve before the under floor heating to prevent condensation on the floor during cooling operation. For more information, see the installer reference guide.

-  Wires: 2×0.75 mm²
- Maximum running current: 100 mA
- 230 V AC supplied by PCB
-  [2.D] Shut off valve

- 1 Open the following (see "3.2.1 To open the indoor unit" on page 6):

- | | |
|---|----------------------------|
| 1 | Top panel |
| 2 | User interface panel |
| 3 | Installer switch box cover |

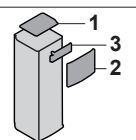

- 2 Connect the valve control cable to the appropriate terminals as shown in the illustration below.

NOTICE

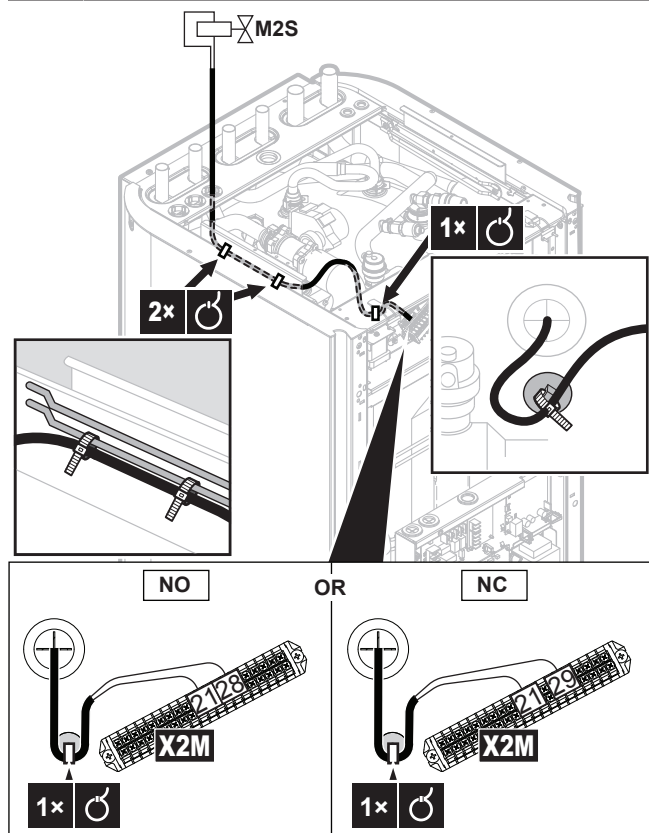

Wiring is different for a NC (normal closed) valve and a NO (normal open) valve.



- 3 Fix the cable with cable ties to the cable tie mountings.

5 Electrical installation

5.6 To connect the electricity meters

	Wires: 2 (per meter)×0.75 mm ²
	Electrical meters: 12 V DC pulse detection (voltage supplied by PCB)
	[9.A] Energy metering



INFORMATION

In case of an electrical meter with transistor output, check the polarity. The positive polarity **MUST** be connected to X5M/6 and X5M/4; the negative polarity to X5M/5 and X5M/3.

- 1 Open the following (see "3.2.1 To open the indoor unit" on page 6):

1	Top panel
2	User interface panel
3	Installer switch box cover

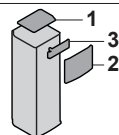

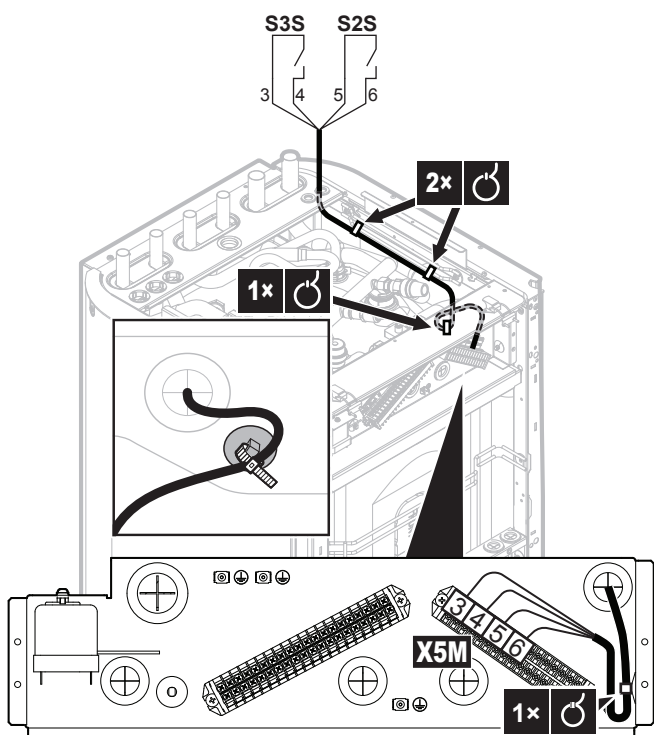

- 2 Connect the electrical meters cable to the appropriate terminals as shown in the illustration below.



- 3 Fix the cable with cable ties to the cable tie mountings.

5.7 To connect the domestic hot water pump

	Wires: (2+GND)×0.75 mm ²
	DHW pump output. Maximum load: 2 A (inrush), 230 V AC, 1 A (continuous)
	[9.2.2] DHW pump [9.2.3] DHW pump schedule

- 1 Open the following (see "3.2.1 To open the indoor unit" on page 6):

1	Top panel
2	User interface panel
3	Installer switch box cover

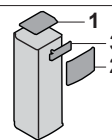

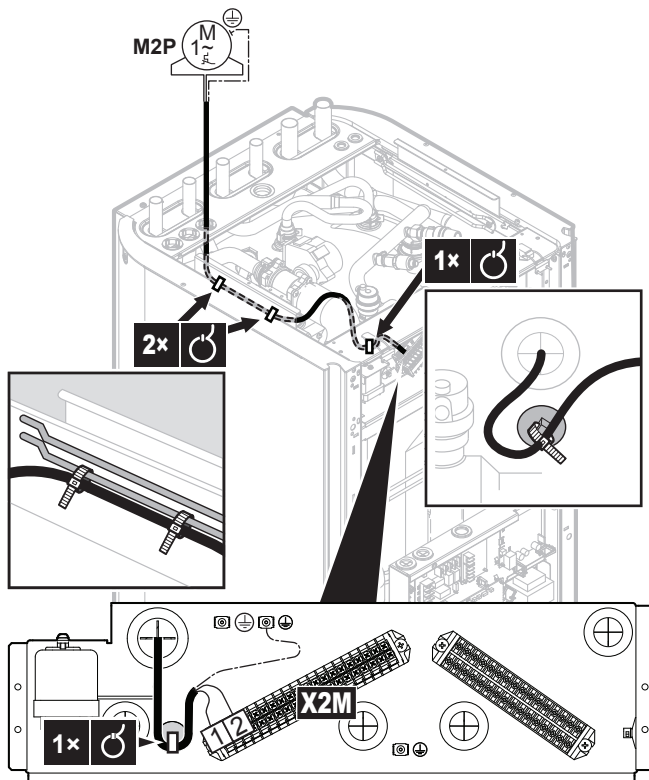

- 2 Connect the domestic hot water pump cable to the appropriate terminals as shown in the illustration below.



- 3 Fix the cable with cable ties to the cable tie mountings.

5.8 To connect the alarm output

	Wires: (2+1)×0.75 mm ²
	Maximum load: 0.3 A, 250 V AC
	[9.D] Alarm output

- 1 Open the following (see "3.2.1 To open the indoor unit" on page 6):

1	Top panel
2	User interface panel
3	Front panel
4	Installer switch box cover
5	Main switch box cover

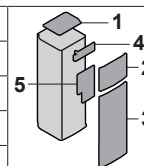

- 2 Connect the alarm output cable to the appropriate terminals as shown in the illustration below. Make sure to put wires 2 and 3 between the installer switch box and main switch box in a cable sleeve (field supply) so that they are double insulated.

2	1	1+2	Wires connected to the alarm output
2	1	3	Wire between the installer switch box and main switch box
a	2	a	Installation of EKR1HB is required.
b	3	b	Cable sleeve (field supply)

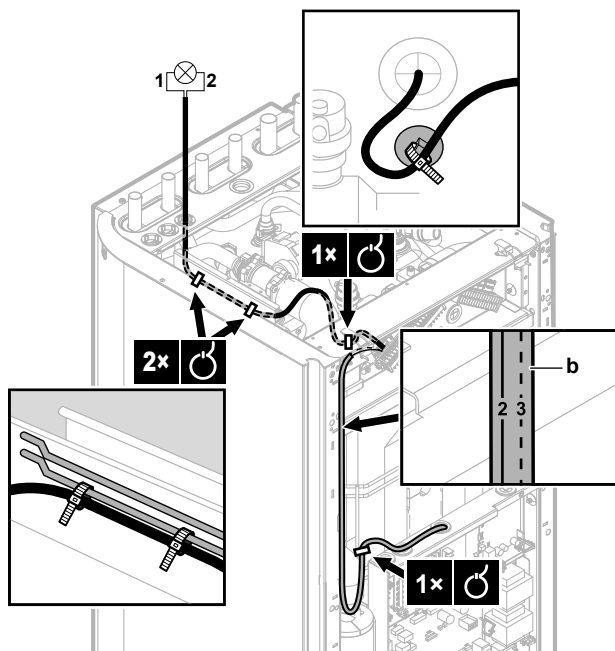

1	Top panel
2	User interface panel
3	Front panel
4	Installer switch box cover
5	Main switch box cover

- 2 Connect the alarm output cable to the appropriate terminals as shown in the illustration below. Make sure to put wires 2 and 3 between the installer switch box and main switch box in a cable sleeve (field supply) so that they are double insulated.

2	1	1+2	Wires connected to the alarm output
X2M	14a 21	3	Wire between the installer switch box and main switch box
a	2	a	Installation of EKR1HB is required.
A4P	Y2 YC	b	Cable sleeve (field supply)

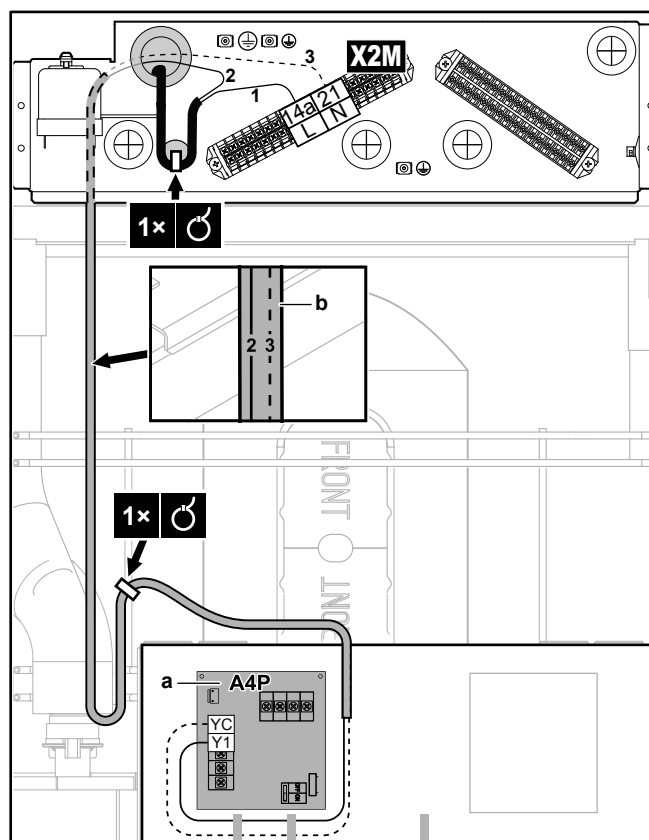

- 3 Fix the cable with cable ties to the cable tie mountings.

5.9 To connect the space cooling/heating ON/OFF output

	Wires: (2+1)×0.75 mm ²
	Maximum load: 3.5 A, 250 V AC

- 1 Open the following (see "3.2.1 To open the indoor unit" on page 6):

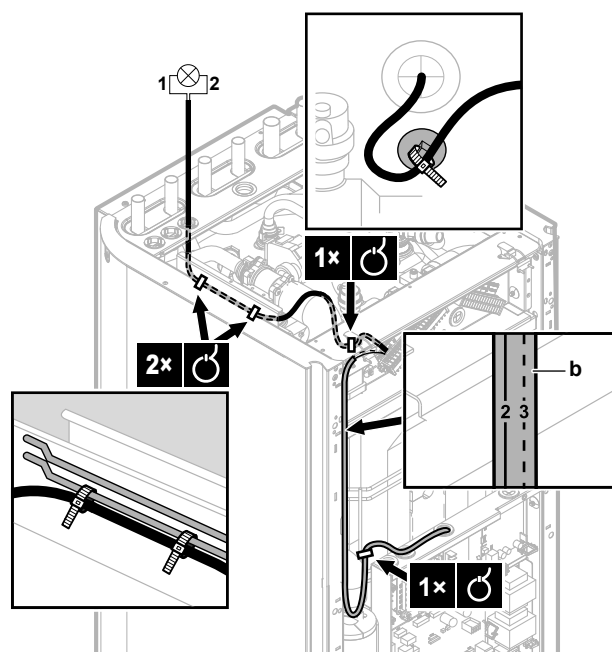

5 Electrical installation

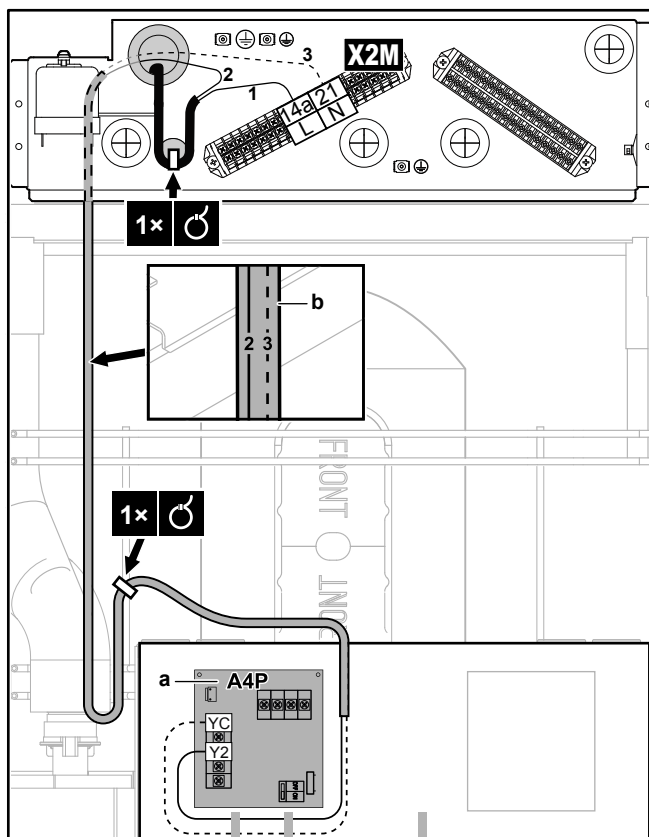

- 3 Fix the cable with cable ties to the cable tie mountings.

5.10 To connect the changeover to external heat source

	Wires: 2×0.75 mm ²
	Maximum load: 0.3 A, 250 V AC
	Minimum load: 20 mA, 5 V DC
	[9.C] Bivalent

- 1 Open the following (see "3.2.1 To open the indoor unit" on page 6):

1	Top panel
2	User interface panel
3	Front panel
4	Main switch box cover

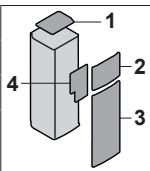

- 2 Connect the changeover to external heat source cable to the appropriate terminals as shown in the illustration below.

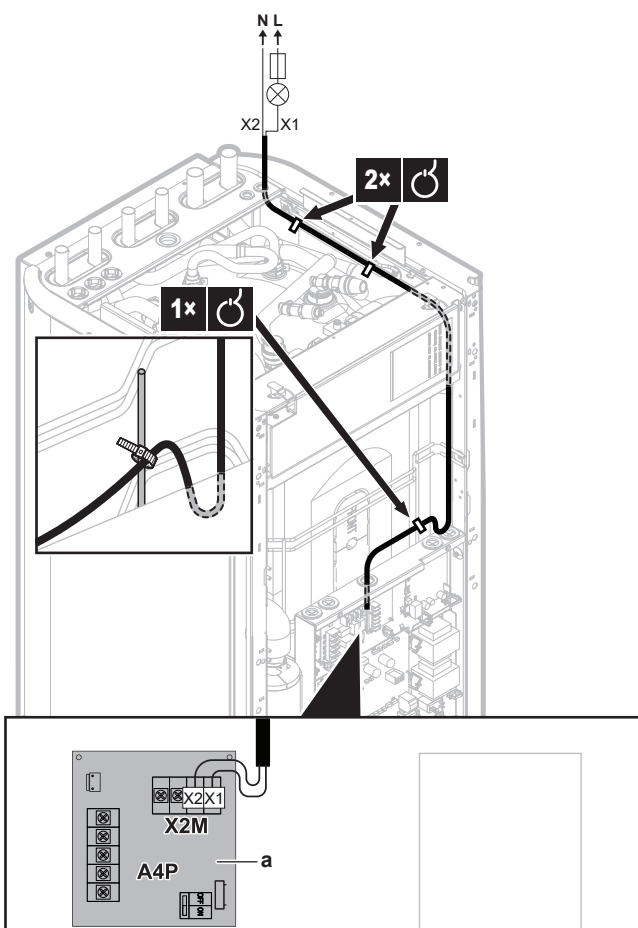

a Installation of EKR1HB is required.

- 3 Fix the cable with cable ties to the cable tie mountings.

5.11 To connect the power consumption digital inputs

	Wires: 2 (per input signal)×0.75 mm ²
	Power limitation digital inputs: 12 V DC / 12 mA detection (voltage supplied by PCB)
	[9.9] Power consumption control.

- 1 Open the following (see "3.2.1 To open the indoor unit" on page 6):

1	Top panel
2	User interface panel
3	Front panel
4	Main switch box cover

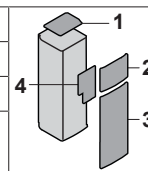

- 2 Connect the power consumption digital inputs cable to the appropriate terminals as shown in the illustration below.

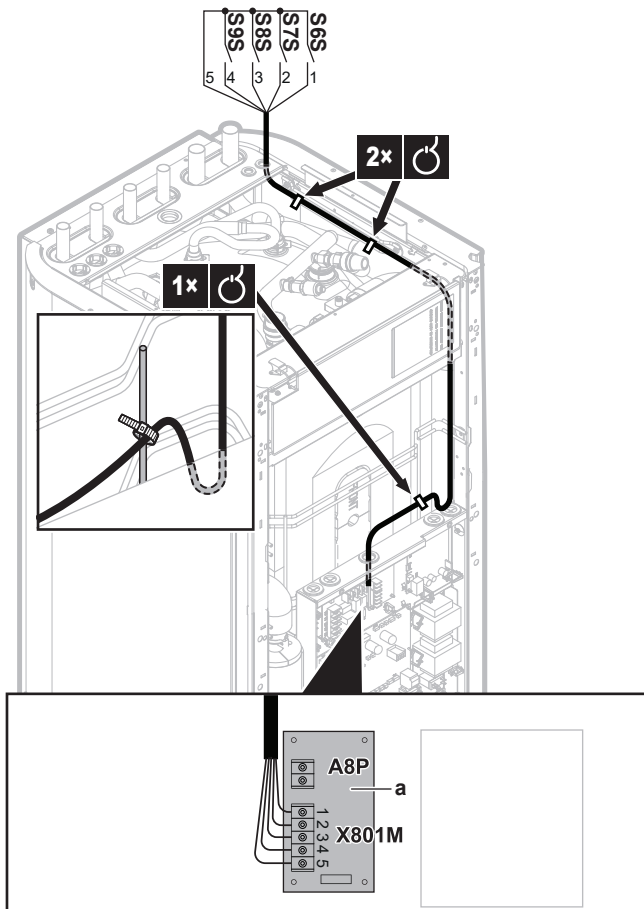

a Installation of EKR1AHTA is required.

3 Fix the cable with cable ties to the cable tie mountings.

5.12 To connect the safety thermostat (normal closed contact)

	Wires: 2×0.75 mm ²
	Safety thermostat contact: 16 V DC detection (voltage supplied by PCB)
	[9.8.1]=3 (Benefit kWh power supply = Safety thermostat)

1 Open the following (see "3.2.1 To open the indoor unit" on page 6):

1	Top panel
2	User interface panel
3	Installer switch box cover

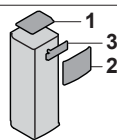

2 Connect the safety thermostat (normal closed) cable to the appropriate terminals as shown in the illustration below.

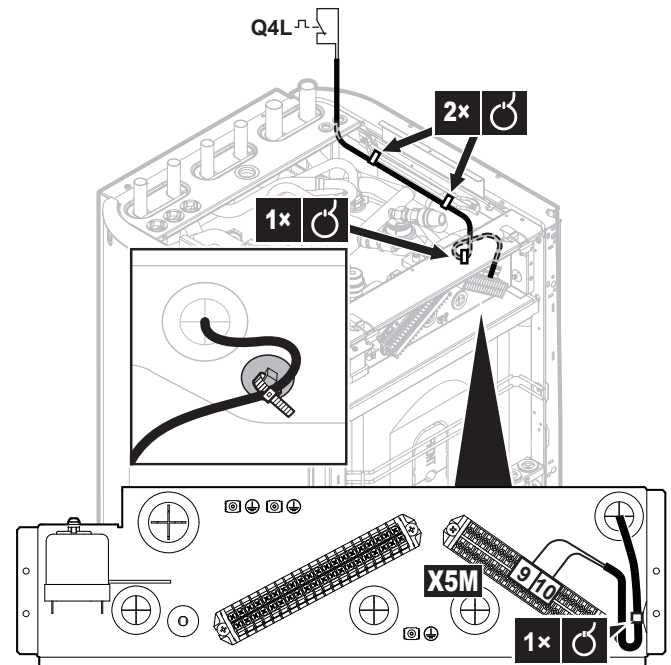

3 Fix the cable with cable ties to the cable tie mountings.



NOTICE

Make sure to select and install the safety thermostat according to the applicable legislation.

In any case, to prevent unnecessary tripping of the safety thermostat, it is recommended that ...

- ... the safety thermostat is automatically resettable.
- ... the safety thermostat has a maximum temperature variation rate of 2°C/min.
- ... there is a minimum distance of 2 m between the safety thermostat and the 3-way valve.



INFORMATION

After it is installed, do NOT forget to configure the safety thermostat. Without configuration, the indoor unit will ignore the safety thermostat contact.



INFORMATION

The preferential kWh rate power supply contact is connected to the same terminals (X5M/9+10) as the safety thermostat. It is only possible for the system to have EITHER preferential kWh rate power supply OR a safety thermostat.

5.13 To connect the brine low pressure switch

Depending on the applicable legislation, you might have to install a brine low pressure switch (field supply).



NOTICE

We recommend to use a mechanical brine pressure switch. If an electrical brine pressure switch is used, capacitive currents might disturb the flow switch operation causing an error on the unit.



Wires: 2×0.75 mm²

5 Electrical installation



Set overview field setting [C-0B]=1.

- If [C-0B]=0 (brine low pressure switch not installed), the unit does not check the input.
- If [C-0B]=1 (brine low pressure switch installed), the unit checks the input. If the input is "open", error EJ-01 occurs.

1 Open the following (see "3.2.1 To open the indoor unit" on page 6):

1	Top panel
2	User interface panel
3	Installer switch box cover

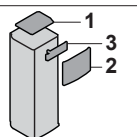

2 Connect the brine low pressure switch cable as shown in the illustration below.

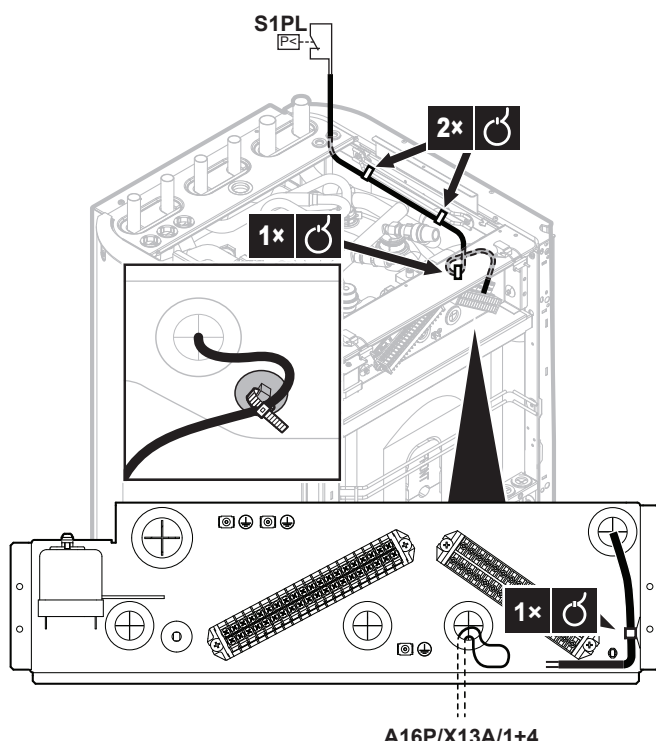

A16P/X13A/1+4

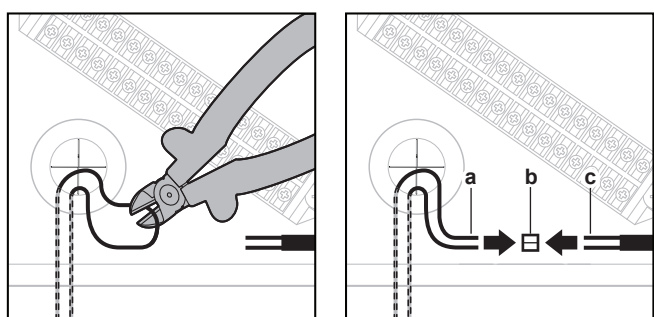

- Cut loop wires coming from A16P/X13A/1+4 (factory mounted)
- Splicing connectors (field supply)
- Wires from the brine low pressure switch cable (field supply)

3 Fix the cable with cable ties to the cable tie mountings.

5.14 LAN adapter

5.14.1 About the LAN adapter

The indoor unit contains an integrated LAN adapter (model: BRP069A61), which allows for:

- App control of the Daikin Altherma heat pump system

- Integration of the heat pump system in a Smart Grid application

Components: PCB

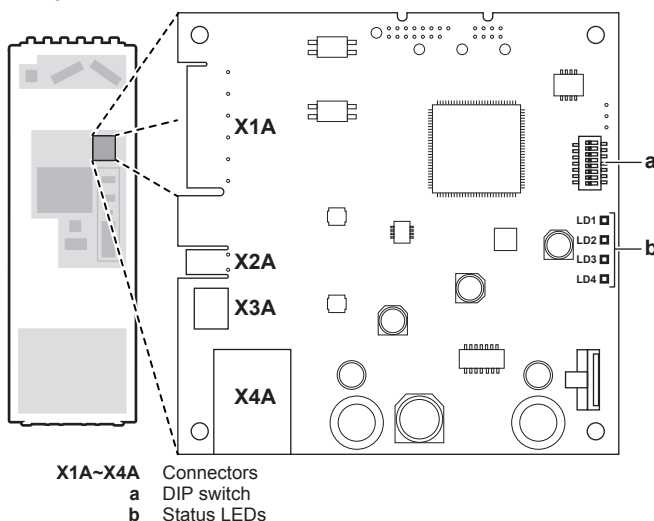

Status LEDs

LED	Description	Behaviour
LD1 ♥	Indication of power to the adapter, and of normal operation.	<ul style="list-style-type: none"> ▪ LED flashing: normal operation. ▪ LED NOT flashing: no operation.
LD2 □	Indication of TCP/IP communication with the router.	<ul style="list-style-type: none"> ▪ LED ON: normal communication. ▪ LED flashing: communication problem.
LD3 P1P2	Indication of communication with the indoor unit.	<ul style="list-style-type: none"> ▪ LED ON: normal communication. ▪ LED flashing: communication problem.
LD4 ⚡	Indication of Smart Grid activity.	<ul style="list-style-type: none"> ▪ LED ON: Smart Grid functionality of the indoor unit is controlled by the LAN adapter. ▪ LED OFF: system operating in normal operation conditions (space heating/cooling, production of domestic hot water), or running in the "Normal operation"/"Free running" Smart Grid operation mode.

System requirements

The requirements posed on the Daikin Altherma system depend on the LAN adapter application/system layout.

App control

Item	Requirement
LAN adapter software	It is recommended to ALWAYS keep the LAN adapter software up-to-date.
Unit control method	On the user interface, make sure to set [2.9]=2 (Control = Room thermostat).

Smart Grid application

Item	Requirement
LAN adapter software	It is recommended to ALWAYS keep the LAN adapter software up-to-date.
Unit control method	On the user interface, make sure to set [2.9]=2 (Control = Room thermostat).
Domestic hot water settings	To allow for energy buffering in the domestic hot water tank, on the user interface, make sure to set [9.1.3.3]=4 (Domestic hot water = Integrated).
Power consumption control settings	On the user interface, make sure to set: <ul style="list-style-type: none"> [9.9.1]=1 (Power consumption control = Continuous) [9.9.2]=1 (Type = kW)



INFORMATION

For instructions on how to perform a software update, see the installer reference guide.

5.14.2 Overview of electrical connections

Connectors

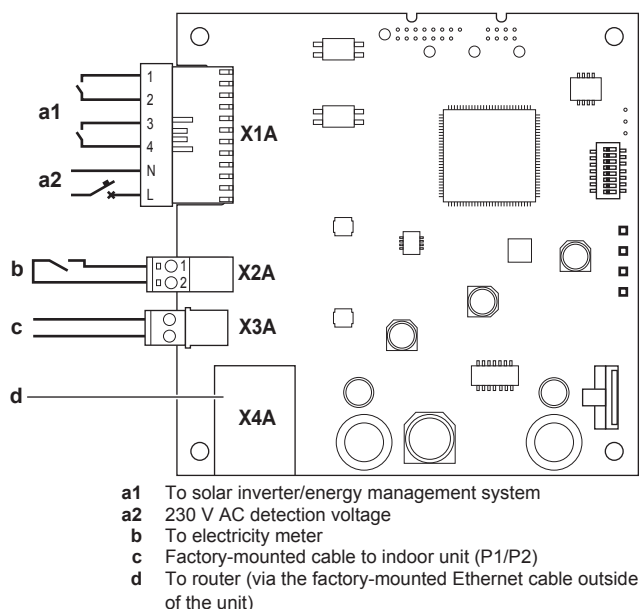

Connections

Field-supplied cables:

Connection	Cable section	Wires	Maximum cable length
Router (via the factory-mounted Ethernet cable outside of the unit, which is coming from X4A)	—	—	50/100 m ^(a)
Electricity meter (X2A)	0.75~1.25 mm ²	2 ^(b)	100 m
Solar inverter/energy management system + 230 V AC detection voltage (X1A)	0.75~1.5 mm ²	Depends on application ^(c)	100 m

- (a) Ethernet cable: Respect the maximum allowed distance between LAN adapter and router, which is 50 m in case of Cat5e cables, and 100 m in case of Cat6 cables.
- (b) These wires MUST be sheathed. Recommended strip length: 6 mm.
- (c) All wiring to X1A MUST be H05VV. Required strip length: 7 mm. For more information, see "5.14.5 Solar inverter/energy management system" on page 22.

5.14.3 Router

Make sure the LAN adapter can be connected via a LAN connection.

The minimum category for the Ethernet cable is Cat5e.

To connect the router

Use one of the following ways (A, B or C) to connect the router:

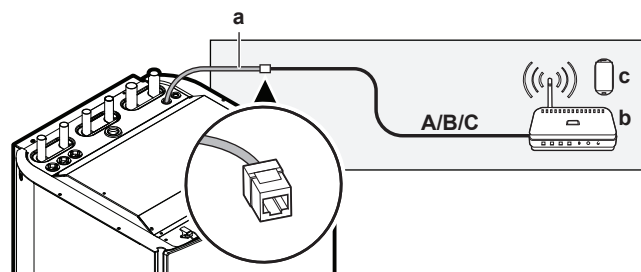

- a Factory-mounted Ethernet cable
- b Router (field supply)
- c Smartphone with app control (field supply)

#	Router connection
A	Wired <p>d Field-supplied Ethernet cable:</p> <ul style="list-style-type: none"> Minimum category: Cat5e Maximum length: <ul style="list-style-type: none"> 50 m in case of Cat5e cables 100 m in case of Cat6 cables
B	Wireless <p>e Wireless bridge (field supply)</p>
C	Power line <p>f Power line adapter (field supply) g Power line (field supply)</p>



INFORMATION

It is recommended to connect the LAN adapter to the router directly. Depending on the wireless bridge or power line adapter model, the system might not function properly.

5 Electrical installation



NOTICE

To prevent communication problems due to cable breakdown, do NOT exceed the minimum bend radius of the Ethernet cable.

5.14.4 Electricity meter

If the LAN adapter is connected to an electricity meter, make sure it is an **electrical pulse meter**.

Requirements:

Item		Specification
Type		Pulse meter (5 V DC pulse detection)
Possible number of pulses		<ul style="list-style-type: none"> 100 pulse/kWh 1000 pulse/kWh
Pulse duration	Minimum On time	10 ms
	Minimum OFF time	100 ms
Measurement type		Depends on the installation: <ul style="list-style-type: none"> Single-phase AC meter Three-phase AC meter (balanced loads) Three-phase AC meter (unbalanced loads)



INFORMATION

It is required that the electricity meter has a pulse output that can measure the total energy injected INTO the grid.

Suggested electricity meters

Phase	ABB reference
Single	2CMA100152R1000 B21 212-100
Three	2CMA100166R1000 B23 212-100

To connect the electricity meter



NOTICE

To prevent damage to the PCB, it is NOT allowed to connect the electrical wiring with the connectors already connected to the PCB. First connect the wiring to the connectors, then connect the connectors to the PCB.

- 1 Open the following (see "3.2.1 To open the indoor unit" on page 6):

1	Top panel	
2	User interface panel	
3	Front panel	
4	Main switch box cover	

- 2 Connect the electricity meter to LAN adapter terminals X2A/1+2.

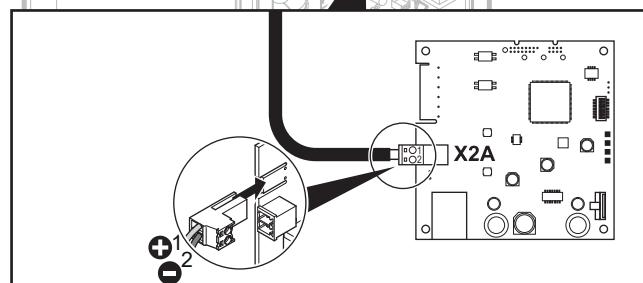
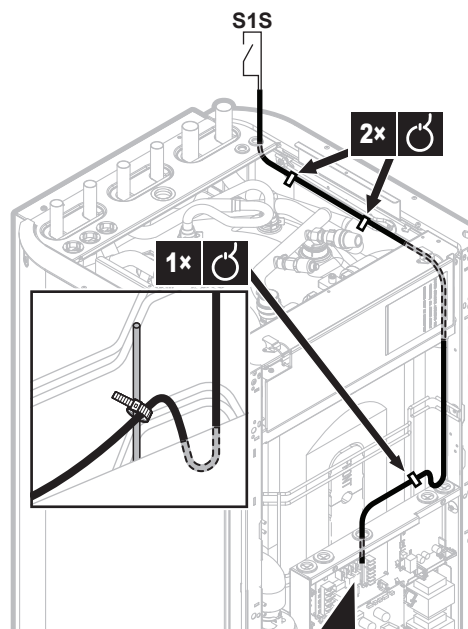

INFORMATION

Mind the polarity of the cable. The positive wire MUST be connected to X2A/1; the negative wire to X2A/2.



WARNING

Make sure to connect the electricity meter in the correct direction, so that it measures the total energy injected INTO the grid.

5.14.5 Solar inverter/energy management system



INFORMATION

Before installation, confirm that the solar inverter/energy management system is equipped with the digital outputs required to connect it to the LAN adapter. For more information, see the installer reference guide.

Connector X1A is for the connection of the LAN adapter to the digital outputs of a solar inverter/energy management system, and allows for the integration of the Daikin Altherma system in a Smart Grid application.

X1A/N+L supply a 230 V AC detection voltage to the input contact of X1A. The 230 V AC detection voltage enables the detection of the state (open or close) of the digital inputs and does NOT supply power to the rest of the LAN adapter PCB.

Make sure X1A/N+L are protected by a fast acting circuit breaker (rated current 100 mA~6 A, type B).

The rest of the wiring to X1A differs depending on the digital outputs available on the solar inverter/energy management system and/or on the Smart Grid operation modes that you want the system to run in.

Smart Grid operation mode	SG0 (X1A/1+2)	SG1 (X1A/3+4)
Normal operation/Free running NO Smart Grid application	Open	Open
Recommended ON Energy buffering in the domestic hot water tank and/or the room, WITH power limitation.	Closed	Open
Forced OFF Deactivation of outdoor unit and electrical heater operation in case of high energy tariffs.	Open	Closed
Forced ON Energy buffering in the domestic hot water tank and/or the room, WITHOUT power limitation.	Closed	Closed

For more information, see the installer reference guide.

To connect the solar inverter/energy management system



NOTICE

To prevent damage to the PCB, it is NOT allowed to connect the electrical wiring with the connectors already connected to the PCB. First connect the wiring to the connectors, then connect the connectors to the PCB.



INFORMATION

How the digital inputs are connected to X1A depends on the Smart Grid application. The connection described in the instructions below is for the system to run in the "Recommended ON" operation mode. For more information, see the installer reference guide.



WARNING

Make sure X1A/N+L are protected by a fast acting circuit breaker (rated current 100 mA~6 A, type B).



WARNING

When connecting the wiring to LAN adapter terminal X1A, make sure each wire is securely fastened to the appropriate terminal. Use a screwdriver to open the wire clamps. Make sure the bare copper wire is fully inserted into the terminal (bare copper wire CANNOT be visible).

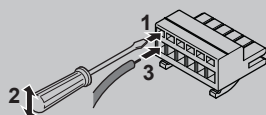

- 1 Open the following (see ["3.2.1 To open the indoor unit" on page 6](#)):

1	Top panel
2	User interface panel
3	Front panel
4	Main switch box cover

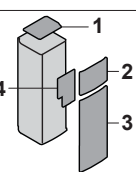

- 2 Provide a detection voltage to X1A/N+L. Make sure X1A/N+L are protected by a fast acting circuit breaker (100 mA~6 A, type B).
- 3 For the system to run in the "Recommended ON" operation mode (Smart Grid application), connect the digital outputs of the solar inverter/energy management system to LAN adapter digital inputs X1A/1+2 LAN.

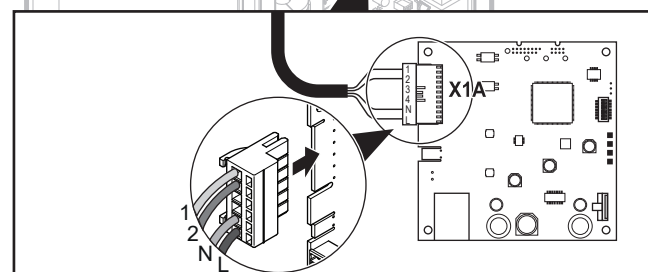
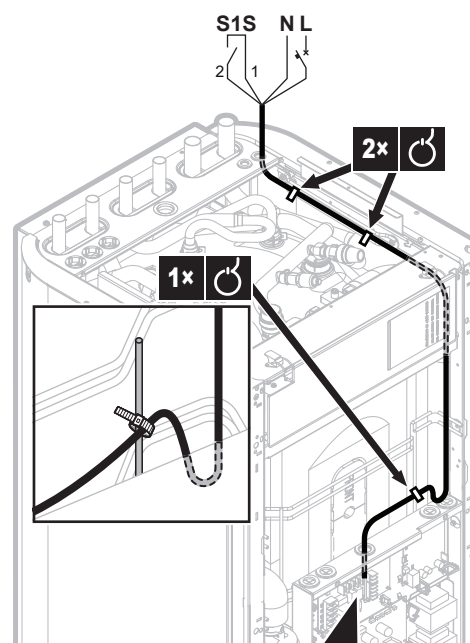

6 Configuration

6.1 Overview: Configuration

This chapter describes what you have to do and know to configure the system after it is installed.



NOTICE

The explanation about the configuration in this chapter gives you ONLY basic explanations. For more detailed explanation and background information, see the installer reference guide.

Why

If you do NOT configure the system correctly, it might NOT work as expected. The configuration influences the following:

- The calculations of the software
- What you can see on and do with the user interface

How

You can configure the system via the user interface.

- **First time – Configuration wizard.** When you turn ON the user interface for the first time (via the indoor unit), the configuration wizard starts to help you configure the system.
- **Restart the configuration wizard.** If the system is already configured, you can restart the configuration wizard. To restart the configuration wizard, go to Installer settings > Configuration wizard. To access Installer settings, see ["6.1.1 To access the most used commands" on page 24](#).
- **Afterwards.** If necessary, you can make changes to the configuration in the menu structure or the overview settings.

6 Configuration



INFORMATION

When the configuration wizard is finished, the user interface will show an overview screen and request to confirm. When confirmed, the system will restart and the home screen will be displayed.

Accessing settings – Legend for tables

You can access the installer settings using two different methods. However, NOT all settings are accessible via both methods. If so, the corresponding table columns in this chapter are set to N/A (not applicable).

Method	Column in tables
Accessing settings via the breadcrumb in the home menu screen or the menu structure . To enable breadcrumbs, press the ? button in the home screen.	# For example: [9.1.5.2]
Accessing settings via the code in the overview field settings .	Code For example: [C-07]

See also:

- "To access the installer settings" on page 24
- "6.4 Menu structure: Overview installer settings" on page 30

6.1.1 To access the most used commands

To change the user permission level

You can change the user permission level as follows:

1	Go to [B]: User profile.	
2	Enter the applicable code for the user permission.	—
	▪ Move the cursor from left to right.	
	▪ Browse through the list of digits and change the selected digit.	
	▪ Confirm the pincode and proceed.	

Installer pin code

The Installer pin code is **5678**. Additional menu items and installer settings are now available.

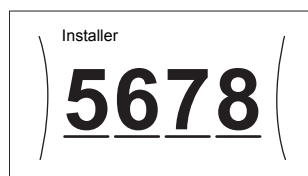

Advanced user pin code

The Advanced user pin code is **1234**. Additional menu items for the user are now visible.

User pin code

The User pin code is **0000**.

To access the installer settings

- 1 Set the user permission level to Installer.
- 2 Go to [9]: Installer settings.

To modify an overview setting

Example: Modify [1-01] from 15 to 20.

Most settings can be configured via the menu structure. If for any reason it is required to change a setting using the overview settings, then the overview settings can be accessed as follows:

1	Set the user permission level to Installer. See "To change the user permission level" on page 24.	—
2	Go to [9.I]: Installer settings > Overview field settings.	

3	Turn the left dial to select the first part of the setting and confirm by pressing the dial.	
4	Turn the left dial to select the second part of the setting	
5	Turn the right dial to modify the value from 15 to 20.	
6	Press the left dial to confirm the new setting.	
7	Press the center button to go back to the home screen.	



INFORMATION

When you change the overview settings and you go back to the home screen, the user interface will show a popup screen and request to restart the system.

When confirmed, the system will restart and recent changes will be applied.

6.2 Configuration wizard

After first power ON of the system, the user interface will guide you using the configuration wizard. This way you can set the most important initial settings. This way the unit will be able to run properly. Afterwards, more detailed settings can be done via the menu structure if required.

6.2.1 Configuration wizard: Language

#	Code	Description
[7.1]	N/A	Language

6.2.2 Configuration wizard: Time and date

#	Code	Description
[7.2]	N/A	Set the local time and date



INFORMATION

By default, daylight savings time is enabled and clock format is set to 24 hours. These settings can be changed during initial configuration or via the menu structure [7.2]: User settings > Time/date.

6.2.3 Configuration wizard: System

Indoor unit type

The indoor unit type is displayed, but cannot be adjusted.

Backup heater type

The backup heater is adapted to be connected to most common European electricity grids. The type of backup heater must be set on the user interface. For units with a built-in backup heater, the type of heater can be viewed but not changed.

Domestic hot water

The following setting determines if the system can prepare domestic hot water or not, and which tank is used. This setting is read only.

#	Code	Description
[9.2.1]	[E-05] ^(*)	▪ No DHW (domestic hot water)
	[E-06] ^(*)	▪ Integrated
	[E-07] ^(*)	The backup heater will also be used for domestic hot water heating.

(*) Menu structure setting [9.2.1] replaces the following 3 overview settings:

- [E-05] Can the system prepare domestic hot water?
- [E-06] Is a domestic hot water tank installed in the system?
- [E-07] What kind of domestic hot water tank is installed?

Emergency

When the heat pump fails to operate, the backup heater can serve as an emergency heater. It then takes over the heat load either automatically or by manual interaction.

- When Emergency is set to Automatic and a heat pump failure occurs, the backup heater automatically takes over the domestic hot water production and space heating.
- When Emergency is set to Manual and a heat pump failure occurs, the domestic hot water heating and space heating stops. To manually recover it via the user interface, go to the Malfunctioning main menu screen and confirm whether the backup heater can take over the heat load or not.
- Alternatively, set Emergency to one of the following modes:
 - auto SH reduced/DHW on: space heating is reduced but domestic hot water is still available.
 - auto SH reduced/DHW off: space heating is reduced and domestic hot water is NOT available.
 - auto SH normal/DHW off: space heating operates as normally but domestic hot water is NOT available.

Similarly as in Manual mode, the unit can take the full load with the backup heater if the user activates this via the Malfunctioning main menu screen.

To keep energy consumption low, we recommend to set Emergency to auto SH reduced/DHW off if the house is unattended for longer periods.

#	Code	Description
[9.5.1]	N/A	▪ 0: Manual ▪ 1: Automatic ▪ 2: auto SH reduced/DHW on ▪ 3: auto SH reduced/DHW off ▪ 4: auto SH normal/DHW off



INFORMATION

If a heat pump failure occurs and Emergency is not set to Automatic (setting 1), the room frost protection function, the underfloor heating screed dryout function, and the water pipe antifreeze function will remain active even if the user does NOT confirm emergency operation.

Number of zones

The system can supply leaving water to up to 2 water temperature zones. During configuration, the number of water zones must be set.



INFORMATION

Mixing station. If your system layout contains 2 LWT zones, you need to install a mixing station in front of the main LWT zone.

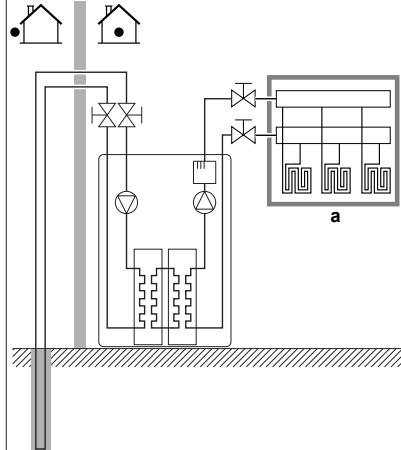
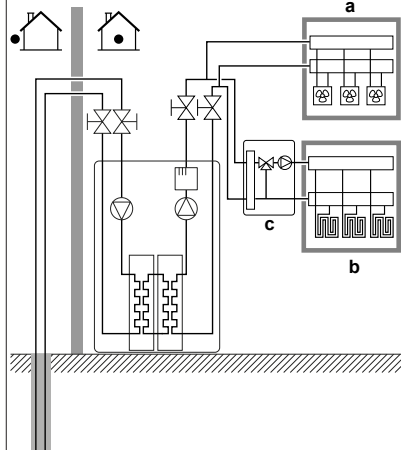
#	Code	Description
[4.4]	[7-02]	▪ 0: Single zone Only one leaving water temperature zone:  ▪ a: Main LWT zone
[4.4]	[7-02]	▪ 1: Dual zone Two leaving water temperature zones. The main leaving water temperature zone consists of the higher load heat emitters and a mixing station to achieve the desired leaving water temperature. In heating:  ▪ a: Additional LWT zone: Highest temperature ▪ b: Main LWT zone: Lowest temperature ▪ c: Mixing station



CAUTION

If there are 2 zones, it is important that the zone with the lowest water temperature is configured as the main zone, and the zone with the highest water temperature is configured as the additional zone. Not configuring the system in this way could cause damage to the heat emitters.

6 Configuration



CAUTION

If there are 2 zones and the emitter types are wrongly configured, water of high temperature can be sent towards a low temperature emitter (underfloor heating). To avoid this:

- Install an aquastat/thermostatic valve to avoid too high temperatures towards a low temperature emitter.
- Make sure you set the emitter types for the main zone [2.7] and for the additional zone [3.7] correctly in accordance with the connected emitter.



NOTICE

An overpressure bypass valve can be integrated in the system. Keep in mind that this valve might not be shown on the illustrations.

6.2.4 Configuration wizard: Backup heater

The backup heater is adapted to be connected to most common European electricity grids. If the backup heater is available, the voltage and maximum capacity must be set on the user interface.

Voltage

Depending on how the backup heater is connected to the grid and what voltage is supplied, the correct value needs to be set. In either configuration, the backup heater will operate in steps of 1 kW.

#	Code	Description
[9.3.2]	[5-0D]	<ul style="list-style-type: none">▪ 0: 230V, 1ph▪ 2: 400V, 3ph

Maximum capacity

During normal operation the maximum capacity is:

- 3 kW for a 230 V, 1N~ unit
- 6 kW for a 400 V, 3N~ unit

The maximum capacity of the backup heater can be limited. The set value depends on the used voltage (see table below) and is then the maximum capacity during emergency operation.

#	Code	Description
[9.3.5]	[4-07] ⁽¹⁾	<ul style="list-style-type: none">0~6 kW when voltage is set to 230 V, 1N~0~9 kW when voltage is set to 400 V, 3N~

(1) If the value [4-07] is set lower, then the lowest value will be used in all operation modes.

6.2.5 Configuration wizard: Main zone

The most important settings for the main leaving water zone can be set here.

Emitter type

Depending on the system water volume and the heater emitter type of the main zone, heating up or cooling down the main zone can take longer. The setting Emitter type can compensate for a slow or a quick heating/cooling system during the heat up/cool down cycle. The target delta T for the main zone depends on this setting.

In room thermostat control, Emitter type influences the maximum modulation of the desired leaving water temperature, and the possibility for usage of the automatic cooling/heating changeover based on the indoor ambient temperature.

It is important to set Emitter type correctly and in accordance with your system layout.

#	Code	Description
[2.7]	[2-0C]	<ul style="list-style-type: none">▪ 0: Underfloor heating▪ 1: Fancoil unit▪ 2: Radiator

The setting of the emitter type has an influence on the space heating setpoint range and the target delta T in heating as follows:

Description	Space heating setpoint range
0: Underfloor heating	Maximum 55°C
1: Fancoil unit	Maximum 65°C
2: Radiator	Maximum 65°C

Control

Defines how the operation of the unit is controlled. There are 3 possibilities:

#	Code	Description
[2.9]	[C-07]	<ul style="list-style-type: none">▪ 0: Leaving water▪ 1: External room thermostat▪ 2: Room thermostat

Schedule

Indicates if the desired leaving water temperature is according to a schedule. Influence of the LWT setpoint mode [2.4] is as follows:

- In Fixed LWT setpoint mode, the scheduled actions consist of desired leaving water temperatures, either preset or custom.
- In Weather dependent LWT setpoint mode, the scheduled actions consist of desired shift actions, either preset or custom.

#	Code	Description
[2.1]	N/A	<ul style="list-style-type: none">▪ 0: No▪ 1: Yes

6.2.6 Configuration wizard: Additional zone

The most important settings for the additional leaving water zone can be set here.

Emitter type

For more info about this functionality, see ["6.2.5 Configuration wizard: Main zone" on page 26](#).

#	Code	Description
[3.7]	[2-0D]	<ul style="list-style-type: none">▪ 0: Underfloor heating▪ 1: Fancoil unit▪ 2: Radiator

Control

The control type is displayed here, but cannot be adjusted. It is determined by the control type of the main zone. For more info about the functionality, see ["6.2.5 Configuration wizard: Main zone" on page 26](#).

#	Code	Description
[3.9]	N/A	<ul style="list-style-type: none">▪ 0: Leaving water if the control type of the main zone is Leaving water.▪ 1: External room thermostat if the control type of the main zone is External room thermostat or Room thermostat.

Schedule

Indicates if the desired leaving water temperature is according to a schedule. Also see ["6.2.5 Configuration wizard: Main zone" on page 26](#).

#	Code	Description
[3.1]	N/A	<ul style="list-style-type: none"> 0: No 1: Yes

6.2.7 Detailed screen with weather-dependent curve

When weather-dependent (WD) operation is active the desired leaving water or tank temperature is determined automatically depending on the averaged outdoor temperature. When the outdoor temperature is lower the leaving water or tank temperature will need to be higher as the water pipes will be colder and vice versa.

WD curve type

#	Code	Description
[2.E]	N/A	<ul style="list-style-type: none"> 0: 2-points 1: Slope-Offset

Slope-offset WD curve

Define the weather-dependent curve by its slope and offset:

- Change the **slope** to differently increase or decrease the temperature of the leaving water for different ambient temperatures. For example, when leaving water temperature is in general fine but at low ambient temperatures too cold, raise the slope so that leaving water temperature is heated increasingly more at decreasingly lower ambient temperatures.
- Change the **offset** to equally increase or decrease the temperature of the leaving water for different ambient temperatures. For example, when leaving water temperature is always a bit too cold at different ambient temperatures, shift the offset up to equally increase the leaving water temperature for all ambient temperatures.

Slope-offset WD curve: example screens

Weather-dependent curve when slope is selected:

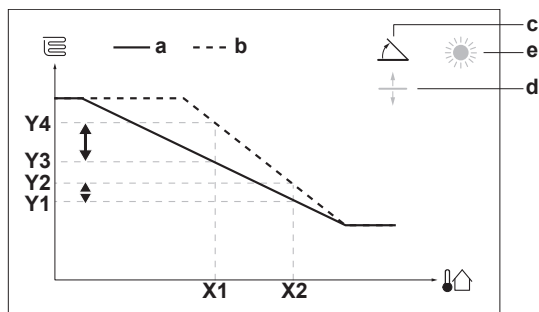

Weather-dependent curve when offset is selected:

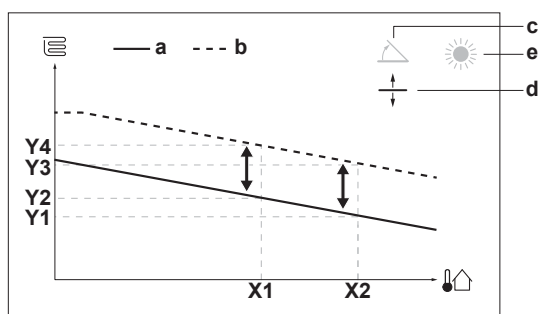

Possible actions on this screen	
	Select slope or offset.
	Increase or decrease the slope/offset.
	When slope is selected: set slope and go to offset. When offset is selected: set offset.
	Confirm changes and return to the submenu.

Item	Description
a	WD curve before changes.
b	WD curve after changes (as example): <ul style="list-style-type: none"> When slope is changed, the new preferred temperature at X1 is unequally higher than the preferred temperature at X2. When offset is changed, the new preferred temperature at X1 is equally higher as the preferred temperature at X2.
c	Slope
d	Offset
e	Possible weather-dependent zones: <ul style="list-style-type: none"> : Main zone or additional zone heating : Main zone or additional zone cooling : Domestic hot water
X1, X2	Outdoor ambient temperature
Y1, Y2, Y3, Y4	Desired tank temperature or leaving water temperature. The symbol shown here corresponds to the heat emitter for that zone: <ul style="list-style-type: none"> : Underfloor heating : Fan coil unit : Radiator : Domestic hot water tank

2-points WD curve

The weather-dependent curve is defined by two setpoints:

- Setpoint (X1, Y2)
- Setpoint (X2, Y1)

Weather-dependent curve:

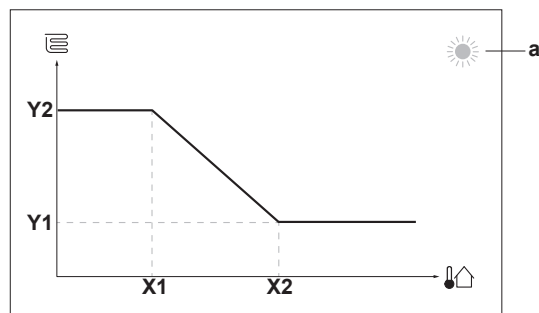

Possible actions on this screen	
	Go through the temperatures.
	Change the temperature.
	Go to the next temperature.
	Confirm changes and proceed.

6 Configuration

Item	Description
a	Possible weather dependent zones: <ul style="list-style-type: none"> Main zone or additional zone heating Main zone or additional zone cooling Domestic hot water
X1, X2	Outdoor ambient temperature
Y1, Y2	Desired tank temperature or leaving water temperature. The symbol shown here corresponds to the heat emitter for that zone: <ul style="list-style-type: none"> Underfloor heating Fan coil unit Radiator Domestic hot water tank

6.2.8 Configuration wizard: Tank

Heat up mode

The domestic hot water can be prepared in 3 different ways. They differ from each other by the way the desired tank temperature is set and how the unit acts upon it.

#	Code	Description
[5.6]	[6-0D]	Heat up mode <ul style="list-style-type: none"> 0: Reheat only: Only reheat operation is allowed. 1: Schedule + reheat: The domestic hot water tank is heated according to a schedule and between the scheduled heat up cycles, reheat operation is allowed. 2: Schedule only: The domestic hot water tank can ONLY be heated according to a schedule.

See the operation manual for more details.

Comfort setpoint

Only applicable when domestic hot water preparation is Schedule only or Schedule + reheat. When programming the schedule, you can make use of the comfort setpoint as a preset value. When you later want to change the storage setpoint, you only have to do it in one place.

The tank will heat up until the **storage comfort temperature** has been reached. It is the higher desired temperature when a storage comfort action is scheduled.

Additionally, a storage stop can be programmed. This feature puts a stop to tank heating even if the setpoint has NOT been reached. Only program a storage stop when tank heating is absolutely undesirable.

#	Code	Description
[5.2]	[6-0A]	Comfort setpoint <ul style="list-style-type: none"> 30°C~[6-0E]°C

Eco setpoint

The **storage economic temperature** denotes the lower desired tank temperature. It is the desired temperature when a storage economic action is scheduled (preferably during day).

#	Code	Description
[5.3]	[6-0B]	Eco setpoint <ul style="list-style-type: none"> 30°C~min(50,[6-0E])°C

Reheat setpoint

Desired reheat tank temperature, used:

- in Schedule + reheat mode, during reheat mode: the guaranteed minimum tank temperature is set by the Reheat setpoint minus the reheat hysteresis. If the tank temperature drops below this value, the tank is heated up.
- during storage comfort, to prioritize the domestic hot water preparation. When the tank temperature rises above this value, domestic hot water preparation and space heating/cooling are executed sequentially.

#	Code	Description
[5.4]	[6-0C]	Reheat setpoint <ul style="list-style-type: none"> 30°C~min(50,[6-0E])°C

6.3 Settings menu

You can set additional settings using the main menu screen and its submenus. The most important settings are presented here.

6.3.1 Main zone

Thermostat type

Only applicable in external room thermostat control.



NOTICE

If an external room thermostat is used, the external room thermostat will control the room frost protection. However, the room frost protection is only possible if [C.2] Space heating/cooling is turned ON.

#	Code	Description
[2.A]	[C-05]	External room thermostat type for the main zone: <ul style="list-style-type: none"> 1: 1 contact: The used external room thermostat can only send a thermo ON/OFF condition. There is no separation between heating or cooling demand. 2: 2 contacts: The used external room thermostat can send a separate heating/cooling thermo ON/OFF condition.

6.3.2 Additional zone

Thermostat type

Only applicable in external room thermostat control. For more info about the functionality, see ["6.3.1 Main zone" on page 28](#).

#	Code	Description
[3.A]	[C-06]	External room thermostat type for the additional zone: <ul style="list-style-type: none"> 1: 1 contact 2: 2 contacts

6.3.3 Information

Dealer information

The installer can fill in his contact number here.

#	Code	Description
[8.3]	N/A	Number that users can call in case of problems.

6.3.4 Brine

Brine freezing temperature

Depending on the type and concentration of the anti-freeze in the brine system, the freezing temperature will differ. The following parameters set the units freeze up prevention limit temperature. To allow for temperature measurement tolerances, the brine concentration **MUST** resist to a lower temperature than the defined setting.

General rule: the units freeze up prevention limit temperature **MUST** be 10°C lower than the minimum possible brine inlet temperature for the unit.

Example: When the minimum possible brine inlet temperature in a certain application is -2°C, then the unit freeze up prevention limit temperature **MUST** be set to -12°C or lower. Result will be that the brine mixture may **NOT** freeze above that temperature. To prevent freezing of the unit, check the type and concentration of the brine carefully.

#	Code	Description
[9.M]	[A-04]	Brine freezing temperature <ul style="list-style-type: none"> ▪ 0: 2°C ▪ 1: -2°C ▪ 2: -4°C ▪ 3: -6°C ▪ 4: -9°C ▪ 5: -12°C ▪ 6: -15°C ▪ 7: -18°C



NOTICE

The Brine freezing temperature setting can be modified and read out in [9.M]. This setting can **ONLY** be modified if the communication between hydro module and compressor module is present. The communication between hydro module and compressor module is **NOT** guaranteed and/or applicable if:

- error "U4" appears on the user interface,
- the heat pump module is connected to preferential kWh rate power supply where power supply is interrupted and preferential kWh rate power supply is activated.

6 Configuration

6.4 Menu structure: Overview installer settings

[9] Installer settings	[9.2] Domestic hot water
Configuration wizard	Domestic hot water
Domestic hot water	DHW pump
Backup heater	DHW pump schedule
Emergency	Solar
Balancing	
Water pipe freeze prevention	
Benefit kWh power supply	
Power consumption control	
Energy metering	
Sensors	
Bivalent	
Alarm output	
Auto restart	
Power saving function	
Disable protections	
Forced defrost	
Overview field settings	
Brine freezing temperature	

(*) Only applicable in Swedish language.



INFORMATION

Depending on the selected installer settings and unit type, settings will be visible/invisible.

7 Commissioning



NOTICE

NEVER operate the unit without thermistors and/or pressure sensors/switches. Burning of the compressor might result.



INFORMATION

The software is equipped with an "installer-on-site" mode ([9.G]: Disable protections), that disables automatic operation by the unit. At first installation, setting Disable protections is by default set to Yes, meaning automatic operation is disabled. All protective functions are then disabled. If the user interface home pages are off, the unit will NOT operate automatically. To enable automatic operation and the protective functions, set Disable protections to No.

36 hours after the first power-on, the unit will automatically set Disable protections to No, ending "installer-on-site" mode and enabling the protective functions. If – after first installation – the installer returns to the site, the installer has to set Disable protections to Yes manually.



NOTICE

Make sure that both the domestic hot water tank and the space heating circuit are filled before turning on the power of the unit.

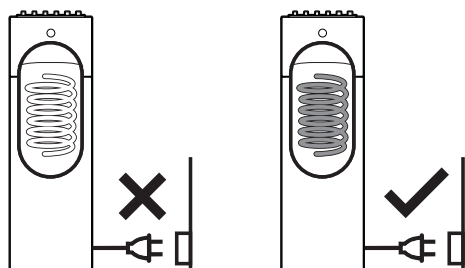

If not filled before turning on power, and in case Emergency is active, the backup heater thermal fuse may blow. To avoid breakdown of the backup heater, fill the unit before turning on power.

7.1 Checklist before commissioning

After the installation of the unit, first check the following items. Once all below checks are fulfilled, the unit **MUST** be closed, **ONLY** then can the unit be powered up.

<input type="checkbox"/>	You read the complete installation instructions, as described in the installer reference guide .
<input type="checkbox"/>	The indoor unit is properly mounted.
<input type="checkbox"/>	The following field wiring has been carried out according to this document and the applicable legislation: <ul style="list-style-type: none"> Between the local supply panel and the indoor unit Between the indoor unit and the valves (if applicable) Between the indoor unit and the room thermostat (if applicable)
<input type="checkbox"/>	The system is properly earthed and the earth terminals are tightened.
<input type="checkbox"/>	The fuses or locally installed protection devices are installed according to this document, and have NOT been bypassed.
<input type="checkbox"/>	The power supply voltage matches the voltage on the identification label of the unit.

<input type="checkbox"/>	There are NO loose connections or damaged electrical components in the switch box.
<input type="checkbox"/>	There are NO damaged components or squeezed pipes on the inside of the indoor unit.
<input type="checkbox"/>	Backup heater circuit breaker F1B (field supply) is turned ON.
<input type="checkbox"/>	The correct pipe size is installed and the pipes are properly insulated.
<input type="checkbox"/>	There is NO water and/or brine leak inside the indoor unit.
<input type="checkbox"/>	There are no odour traces noticeable of the used brine.
<input type="checkbox"/>	The air purge valve is open (at least 2 turns).
<input type="checkbox"/>	The pressure relief valve purges water when opened.
<input type="checkbox"/>	The shut-off valves are properly installed and fully open.
<input type="checkbox"/>	The domestic hot water tank is filled completely.
<input type="checkbox"/>	The brine circuit and water circuit are filled correctly.



NOTICE

When the brine circuit is not ready to be used, the system can be set to HP forced off mode. To do this, set [9.5.2]=1 (HP forced off = enabled).

Space heating and domestic hot water are then provided by the backup heater. Cooling is NOT possible when this mode is active. All commissioning related to or making use of the brine circuit should NOT be performed until the brine circuit is filled and HP forced off is deactivated.

7.2 Checklist during commissioning

<input type="checkbox"/>	To perform an air purge on the water circuit.
<input type="checkbox"/>	To perform an air purge on the brine circuit via brine pump test run or 10-day brine operation function.
<input type="checkbox"/>	To perform a test run .
<input type="checkbox"/>	To perform an actuator test run .
<input type="checkbox"/>	Underfloor screed dryout function The underfloor screed dryout function is started (if necessary).
<input type="checkbox"/>	To start 10-day brine pump operation .

7.2.1 To perform an air purge on the water circuit

1	Set the user permission level to Installer. See "To change the user permission level" on page 24 .	—
2	Go to [A.3]: Commissioning > Air purge.	
3	Select OK to confirm.	
Result: The air purge starts. It stops automatically when air purge cycle is finished.		
To stop the air purge manually:		—
1	Go to Stop air purge.	
2	Select OK to confirm.	

7 Commissioning

7.2.2 To perform an air purge on the brine circuit

There are two ways to perform an air purge on the brine circuit:

- with a brine filling station (field supply)
- with a brine filling station (field supply) in combination with the unit's own brine pump

In both cases, follow the instructions included with the brine filling station. The second method should only be used when the air purge on the brine circuit was NOT successful using only a brine filling station. See "To perform an air purge with a brine filling station" in the installer reference guide for more information.

In case a brine buffer vessel is present in the brine circuit, or if the brine circuit consists of a horizontal loop instead of a vertical borehole, further air purging may be required. You can make use of the 10 day brine pump operation. See ["7.2.6 To start or stop 10-day brine pump operation" on page 33](#) for more information.

7.2.3 To perform an operation test run

1	Set the user permission level to Installer. See "To change the user permission level" on page 24 .	—
2	Go to [A.1]: Commissioning > Operation test run.	
3	Select a test from the list. Example: Heating.	
4	Select OK to confirm. Result: The test run starts. It stops automatically when done (±30 min). To stop the test run manually:	
1	Go to Stop test run.	
2	Select OK to confirm.	

If the installation of the unit has been done correctly, the unit will start up during test operation in the selected operation mode. During test mode, the correct operation of the unit can be checked by monitoring its leaving water temperature (heating/cooling mode) and tank temperature (domestic hot water mode).

To monitor the temperature:

1	Go to Sensors.	
2	Select the temperature information.	

7.2.4 To perform an actuator test run

Purpose of the actuator test run is to confirm the operation of the different actuators (e.g., when you select Pump, a test run of the pump will start).

1	Set the user permission level to Installer. See "To change the user permission level" on page 24 .	—
2	Go to [A.2]: Commissioning > Actuator test run.	
3	Select a test from the list. Example: Pump.	
4	Select OK to confirm. Result: The actuator test run starts. It stops automatically when done (±30 min for Pump, ±120 min for Brine pump, ±10 min for other test runs). To stop the test run manually:	
1	Go to Stop test run.	
2	Select OK to confirm.	

Possible actuator test runs

- Backup heater 1 test (3 kW capacity, only available when no current sensors are used)

- Backup heater 2 test (6 kW capacity, only available when no current sensors are used)
- Pump test



INFORMATION

Make sure that all air is purged before executing the test run. Also avoid disturbances in the water circuit during the test run.

- Shut off valve test
- Diverter valve test
- Bivalent signal test
- Alarm output test
- C/H signal test
- DHW pump test
- Backup heater phase 1 test (3 kW capacity, only available when current sensors are used)
- Backup heater phase 2 test (3 kW capacity, only available when current sensors are used)
- Backup heater phase 3 test (3 kW capacity, only available when current sensors are used)
- Brine pump test

7.2.5 To perform an underfloor heating screed dryout

Conditions:

- Make sure all operation is disabled. Go to [C] Operation and turn off [C.1] Room, [C.2] Space heating/cooling and [C.3] Tank operation.
- Make sure [2.7] and [3.7] Emitter type is set to Underfloor heating.

1	Set the user permission level to Installer. See "To change the user permission level" on page 24 .	—
2	Go to [A.4]: Commissioning > UFH screed dryout.	
3	Set a dryout program: go to Program and use the UFH screed dryout programming screen.	
4	Select OK to confirm. Result: The underfloor heating screed dryout starts. It stops automatically when done. To stop the test run manually:	
1	Go to Stop UFH screed dryout.	
2	Select OK to confirm.	



NOTICE

To perform an underfloor heating screed dryout, room frost protection needs to be disabled ([2-06]=0). By default, it is enabled ([2-06]=1). However, due to the "installer-on-site" mode (see "Commissioning"), room frost protection will be automatically disabled for 36 hours after the first power-on.

If the screed dryout still needs to be performed after the first 36 hours of power-on, manually disable room frost protection by setting [2-06] to "0", and KEEP it disabled until the screed dryout has finished. Ignoring this notice will result in cracking of the screed.

**NOTICE**

For the underfloor heating screed dryout to be able to start, make sure the following settings are met:

- [4-00]=1
- [C-02]=0
- [D-01]=0
- [4-08]=0
- [4-01]≠1

Resume after power failure

If power is restored after a power failure, underfloor heating screed dryout automatically resumes its operation.

7.2.6 To start or stop 10-day brine pump operation

If a brine buffer vessel is part of the brine circuit, or in case a horizontal brine loop is used, it may be required to let the brine pump run continuously for 10 days after the system is commissioned. If 10 day brine pump operation is:

- ON: The unit operates as normal, except that the brine pump operates continuously for 10 days, independent of compressor status.
- OFF: Brine pump operation is linked to compressor status.

Conditions: All other commissioning tasks have been completed before starting the 10 day brine pump operation. After you have done this, 10 day brine pump operation can be activated in the commissioning menu.

1	Set the user permission level to Installer. See "To change the user permission level" on page 24.	—
2	Go to [A.6]: Commissioning > 10 day brine pump operation.	
3	Select On to start the 10 day brine pump operation. Result: The 10 day brine pump operation starts.	

During the 10 day brine pump operation, the setting will be displayed as ON in the menu. Once the procedure has been completed, it will change to OFF automatically.

**NOTICE**

The 10-day brine pump operation will only start if there are no errors present on the main menu screen and the timer will only count down if either an underfloor heating screed dryout is started, or if Space heating/cooling or Tank operation is enabled.

8 Hand-over to the user

Once the test run is finished and the unit operates properly, please make sure the following is clear for the user:

- Fill in the installer setting table (in the operation manual) with the actual settings.
- Make sure that the user has the printed documentation and ask him/her to keep it for future reference. Inform the user that he can find the complete documentation at the URL mentioned earlier in this manual.
- Explain the user how to properly operate the system and what to do in case of problems.
- Show the user what to do for the maintenance of the unit.

9 Technical data

A **subset** of the latest technical data is available on the regional Daikin website (publicly accessible). The **full set** of latest technical data is available on the Daikin Business Portal (authentication required).

9.1 Piping diagram: Indoor unit

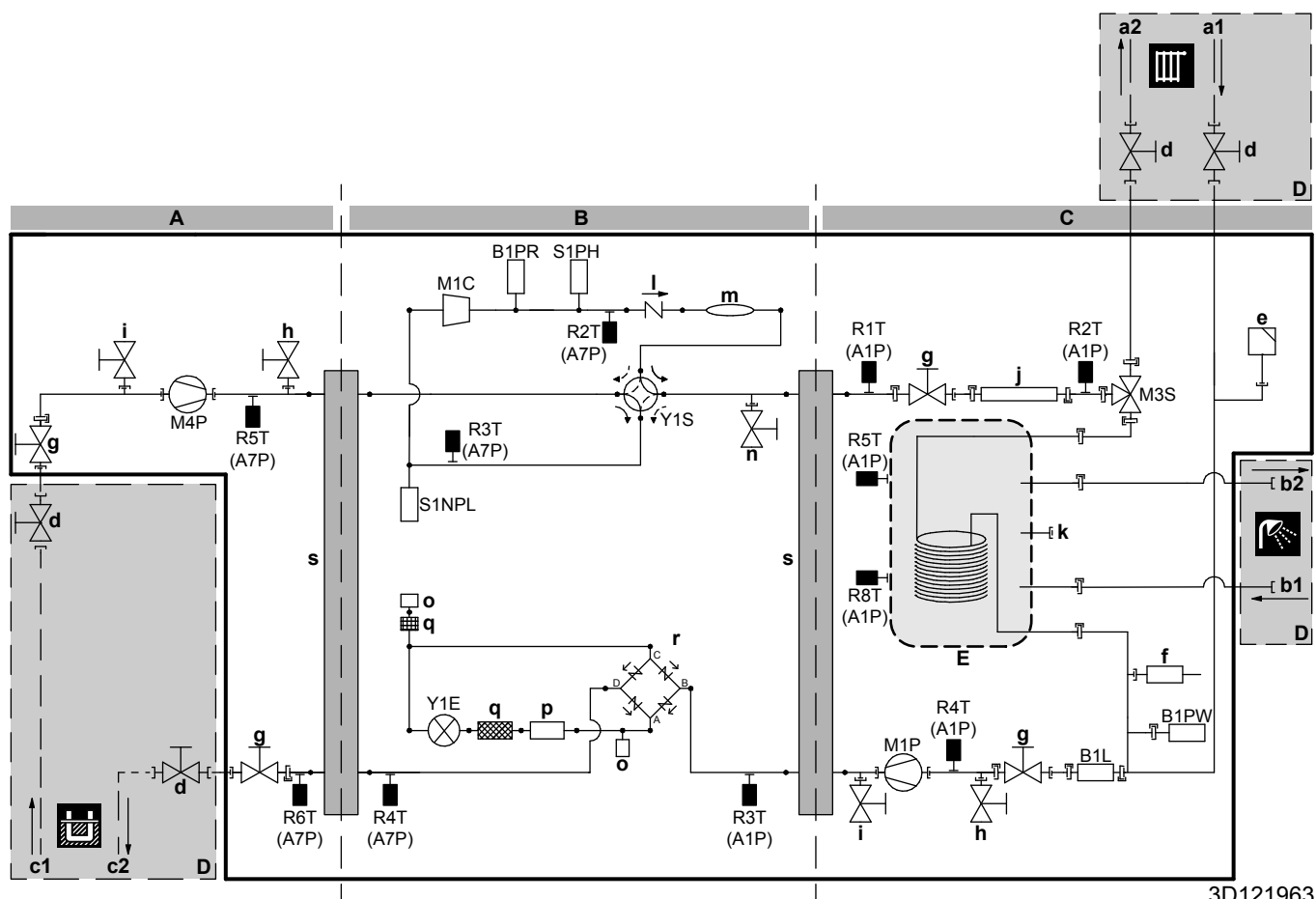

3D121963

- A** Brine side
- B** Refrigerant side
- C** Water side
- D** Field installed
- E** DHW tank
- a1** Space heating water IN (Ø22 mm)
- a2** Space heating water OUT (Ø22 mm)
- b1** Domestic hot water: cold water IN (Ø22 mm)
- b2** Domestic hot water: hot water OUT (Ø22 mm)
- c1** Brine IN (Ø28 mm)
- c2** Brine OUT (Ø28 mm)
- d** Shut-off valve
- e** Automatic air purge valve
- f** Safety valve
- g** Shut-off valve
- h** Manual air purge valve
- i** Drain valve
- j** Backup heater
- k** Recirculation connection (3/4" G female)
- l** Check valve
- m** Muffler
- n** Refrigerant pressure relief valve
- o** Service port
- p** Heat sink
- q** Filter
- r** Rectifier
- s** Plate heat exchanger

Refrigerant flow:

- Heating
- Cooling

- B1L** Flow sensor
- B1PR** Refrigerant high pressure sensor
- B1PW** Space heating water pressure sensor
- M1C** Compressor
- M1P** Water pump
- M3S** 3-way valve (space heating/domestic hot water)
- M4P** Brine pump
- S1NPL** Low pressure sensor
- S1PH** High pressure switch
- Y1E** Electronic expansion valve
- Y1S** Solenoid valve (4-way valve)

Thermistors:

- R2T (A7P)** Compressor discharge
- R3T (A7P)** Compressor suction
- R4T (A7P)** 2 phase
- R5T (A7P)** Brine IN
- R6T (A7P)** Brine OUT
- R1T (A1P)** Heat exchanger – water OUT
- R2T (A1P)** Backup heater – water OUT
- R3T (A1P)** Liquid refrigerant
- R4T (A1P)** Heat exchanger – water IN
- R5T (A1P)** Tank
- R8T (A1P)** Tank

Connections:

- Screw connection
- Quick coupling
- Brazed connection

9.2 Wiring diagram: Indoor unit

See the internal wiring diagram supplied with the unit (on the inside of the front panel). The abbreviations used are listed below.

Notes to go through before starting the unit

English	Translation
Notes to go through before starting the unit	Notes to go through before starting the unit
X1M	Main terminal
X2M	Field wiring terminal for AC
X5M	Field wiring terminal for DC
-----	Earth wiring
15	Wire number 15
-----	Field supply
→ **/12.2	Connection ** continues on page 12 column 2
①	Several wiring possibilities
	Option
	Mounted in switch box
	Wiring depending on model
	PCB
Backup heater power supply	Backup heater power supply
<input type="checkbox"/> 1N~, 230 V, 3/6 kW	<input type="checkbox"/> 1N~, 230 V, 3/6 kW
<input type="checkbox"/> 3N~, 400 V, 6/9 kW	<input type="checkbox"/> 3N~, 400 V, 6/9 kW
User installed options	User installed options
<input type="checkbox"/> Remote user interface	<input type="checkbox"/> Remote user interface (Human Comfort Interface)
<input type="checkbox"/> Ext. indoor thermistor	<input type="checkbox"/> External indoor thermistor
<input type="checkbox"/> Digital I/O PCB	<input type="checkbox"/> Digital I/O PCB
<input type="checkbox"/> Demand PCB	<input type="checkbox"/> Demand PCB
<input type="checkbox"/> Brine low pressure switch	<input type="checkbox"/> Brine low pressure switch
Main LWT	Main leaving water temperature
<input type="checkbox"/> On/OFF thermostat (wired)	<input type="checkbox"/> On/OFF thermostat (wired)
<input type="checkbox"/> On/OFF thermostat (wireless)	<input type="checkbox"/> On/OFF thermostat (wireless)
<input type="checkbox"/> Ext. thermistor	<input type="checkbox"/> External thermistor
<input type="checkbox"/> Heat pump convector	<input type="checkbox"/> Heat pump convector
Add LWT	Additional leaving water temperature
<input type="checkbox"/> On/OFF thermostat (wired)	<input type="checkbox"/> On/OFF thermostat (wired)
<input type="checkbox"/> On/OFF thermostat (wireless)	<input type="checkbox"/> On/OFF thermostat (wireless)
<input type="checkbox"/> Ext. thermistor	<input type="checkbox"/> External thermistor
<input type="checkbox"/> Heat pump convector	<input type="checkbox"/> Heat pump convector

Position in switch box

English	Translation
Position in switch box	Position in switch box

Legend

A1P	Main PCB (hydro)
A2P	* User interface PCB
A3P	* On/OFF thermostat
A3P	* Heat pump convector
A4P	* Digital I/O PCB
A4P	* Receiver PCB (Wireless On/OFF thermostat, PC=power circuit)
A6P	Backup heater control PCB
A7P	Inverter PCB
A8P	* Demand PCB

A15P	LAN adapter
A16P	ACS digital I/O PCB
CN* (A4P)	* Connector
CT*	* Current sensor
DS1 (A8P)	* DIP switch
F1B	# Overcurrent fuse
F1U~F2U(A4P)	* Fuse (5 A, 250 V)
F2B	# Overcurrent fuse compressor
K*R (A4P)	Relay on PCB
K9M	Thermal protector backup heater relay
M2P	# Domestic hot water pump
M2S	# Shut-off valve
M3P	# Drain pump
PC (A4P)	* Power circuit
PHC1 (A4P)	* Optocoupler input circuit
Q*DI	# Earth leakage circuit breaker
Q1L	Thermal protector backup heater
Q4L	# Safety thermostat
R1T (A2P)	* Thermistor (ambient temperature of the user interface (Human Comfort Interface))
R1T (A3P)	* Thermistor (ambient temperature of the On/OFF thermostat)
R1T (A7P)	Thermistor (outdoor ambient temperature)
R2T (A3P)	* Thermistor (floor temperature or indoor ambient temperature) (in case of wireless On/OFF thermostat)
R6T (A1P)	* Thermistor (indoor ambient temperature) (in case of external indoor ambient thermistor)
R1H (A3P)	* Humidity sensor
S1L	# Low level switch
S1PL	# Brine low pressure switch
S1S	# Preferential kWh rate power supply contact
S2S	# Electricity meter pulse input 1
S3S	# Electricity meter pulse input 2
S6S~S9S	# Digital power limitation inputs
SS1 (A4P)	* Selector switch
TR1, TR2	Power supply transformer
X*A	Connector
X*M	Terminal strip
X*Y	Connector
Z*C	Noise filter (ferrite core)

* Optional

Field supply

Translation of text on wiring diagram

English	Translation
(1) Main power connection	(1) Main power connection
For preferential kWh rate power supply	For preferential kWh rate power supply
Normal kWh rate power supply	Normal kWh rate power supply
Only for preferential kWh rate power supply with separate normal kWh rate power supply	Only for preferential kWh rate power supply with separate normal kWh rate power supply

9 Technical data

English	Translation
Only for preferential kWh rate power supply without separate normal kWh rate power supply	Only for preferential kWh rate power supply without separate normal kWh rate power supply
Preferential kWh rate power supply contact: 16 V DC detection (voltage supplied by PCB)	Preferential kWh rate power supply contact: 16 V DC detection (voltage supplied by PCB)
SWB	Switch box
(2) Power supply BUH	(2) Backup heater power supply
BLK	Black
BLU	Blue
BRN	Brown
GRY	Grey
Only for combined 1F BUH/compressor power supply (3/6 kW)	Only for combined 1F backup heater/compressor power supply (3/6 kW)
Only for combined 3F BUH/compressor power supply (6/9 kW)	Only for combined 3F backup heater/compressor power supply (6/9 kW)
Only for dual cable power supply	Only for dual cable power supply
Only for single cable power supply	Only for single cable power supply
Only for split 1F BUH/1F compressor power supply (3/6 kW)	Only for split 1F backup heater/1F compressor power supply (3/6 kW)
Only for split 3F BUH/1F compressor power supply (6/9 kW)	Only for split 3F backup heater/1F compressor power supply (6/9 kW)
SWB	Switch box
YLW/GRN	Yellow/green
(3) User interface	(3) User interface
Only for remote user interface	Only for remote user interface
SWB	Switch box
(4) Drain pump	(4) Drain pump
SWB	Switch box
(5) Ext. indoor ambient thermistor	(5) External indoor ambient thermistor
SWB	Switch box
(6) Field supplied options	(6) Field supplied options
12 V DC pulse detection (voltage supplied by PCB)	12 V DC pulse detection (voltage supplied by PCB)
230 V AC supplied by PCB	230 V AC supplied by PCB
Continuous	Continuous current
DHW pump	Domestic hot water pump
DHW pump output	Domestic hot water pump output
Electrical meters	Electricity meters
For safety thermostat	For safety thermostat
Inrush	Inrush current
Max. load	Maximum load
Normally closed	Normally closed

English	Translation
Normally open	Normally open
Safety thermostat contact: 16 V DC detection (voltage supplied by PCB)	Safety thermostat contact: 16 V DC detection (voltage supplied by PCB)
Shut-off valve	Shut-off valve
SWB	Switch box
(7) Option PCBs	(7) Option PCBs
Alarm output	Alarm output
Changeover to ext. heat source	Changeover to external heat source
Max. load	Maximum load
Min. load	Minimum load
Only for demand PCB option	Only for demand PCB option
Only for digital I/O PCB option	Only for digital I/O PCB option
Options: ext. heat source output, alarm output	Options: external heat source output, alarm output
Options: On/OFF output	Options: On/OFF output
Power limitation digital inputs: 12 V DC / 12 mA detection (voltage supplied by PCB)	Power limitation digital inputs: 12 V DC / 12 mA detection (voltage supplied by PCB)
Space C/H On/OFF output	Space cooling/heating On/OFF output
SWB	Switch box
(8) External On/OFF thermostats and heat pump convector	(8) External On/OFF thermostats and heat pump convector
Additional LWT zone	Additional leaving water temperature zone
Main LWT zone	Main leaving water temperature zone
Only for external sensor (floor/ambient)	Only for external sensor (floor or ambient)
Only for heat pump convector	Only for heat pump convector
Only for wired On/OFF thermostat	Only for wired On/OFF thermostat
Only for wireless On/OFF thermostat	Only for wireless On/OFF thermostat
(9) Current sensors	(9) Current sensors
SWB	Switch box
(10) Brine pressure loss detection	(10) Brine pressure loss detection
SWB	Switch box
With pressure loss detection	With pressure loss detection
Without pressure loss detection	Without pressure loss detection
(11) Ext. outdoor ambient thermistor	(11) External outdoor ambient thermistor
SWB	Switch box
(12) LAN adapter connection	(12) LAN adapter connection
Ethernet	Ethernet
LAN adapter	LAN adapter
SWB	Switch box

Electrical connection diagram

For more details, please check the unit wiring.

Note:
- In case of signal cable: keep minimum distance to power cables >5 cm

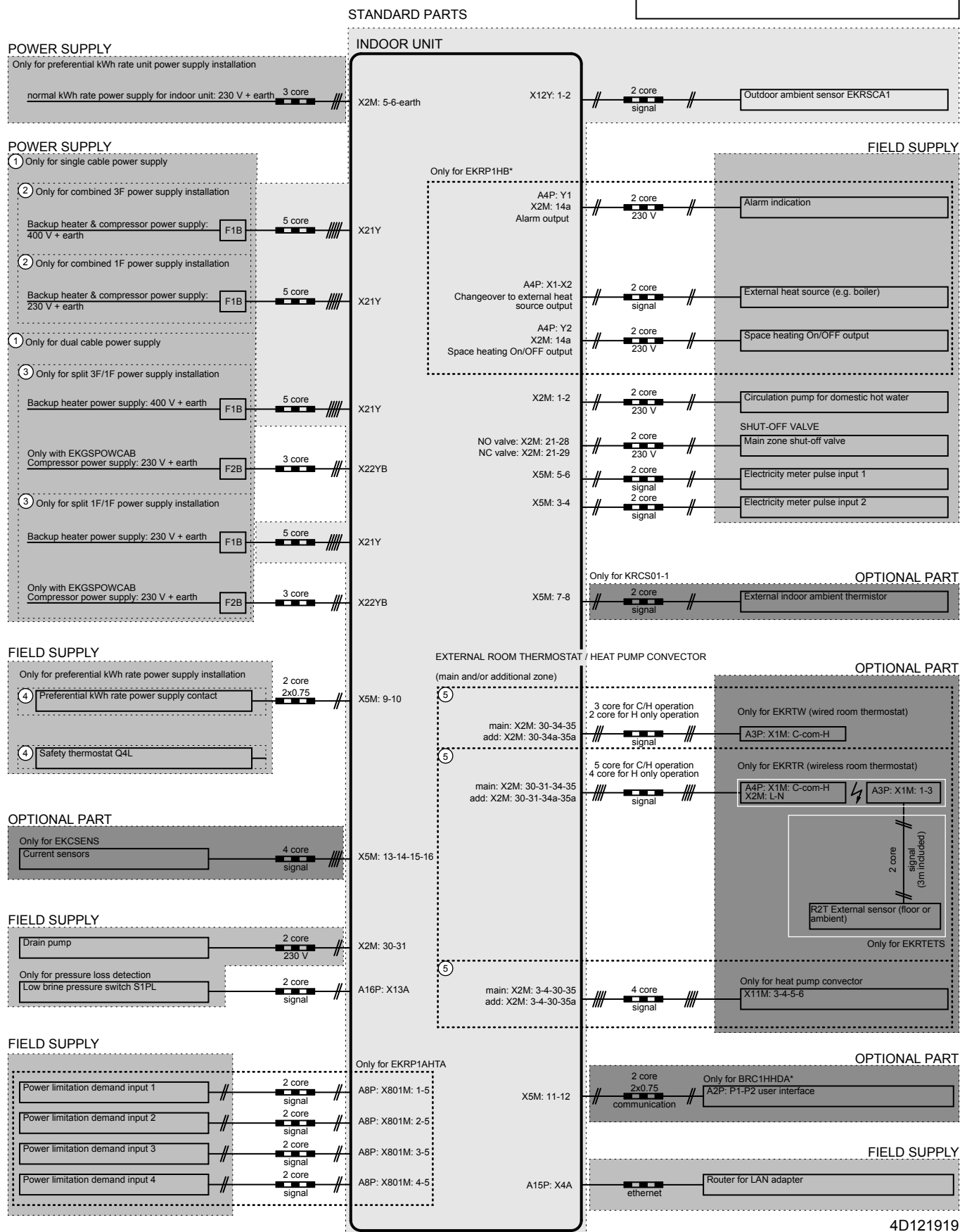

4D121919

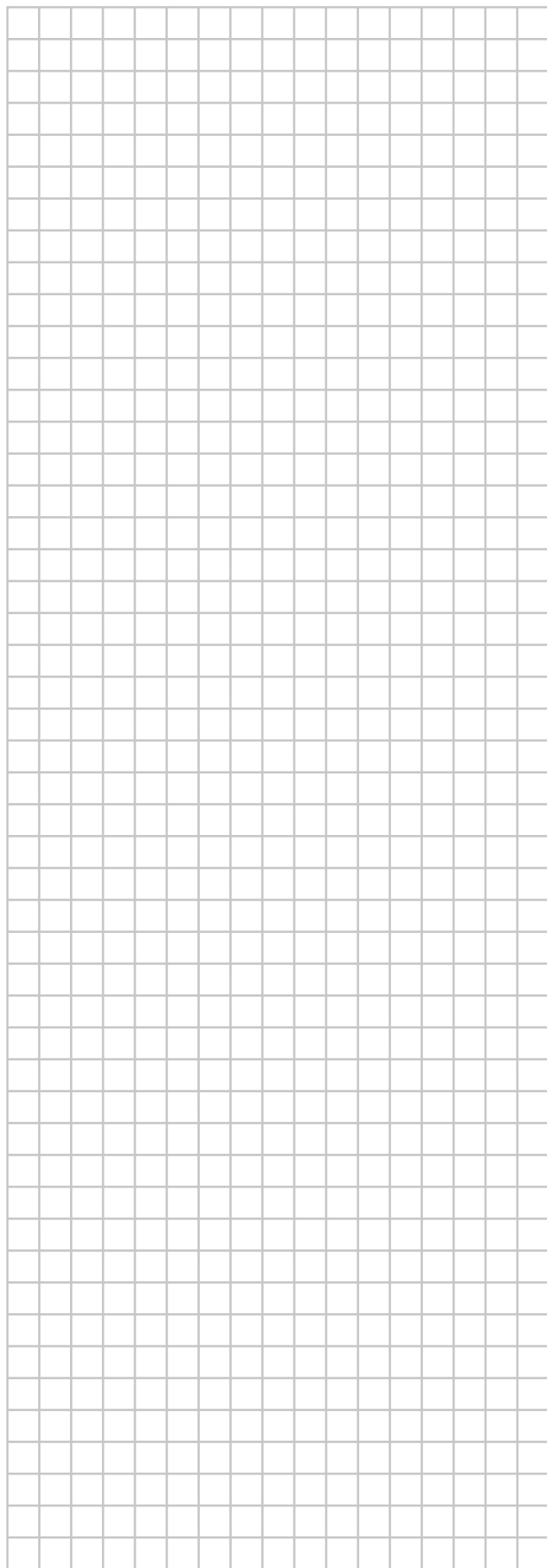

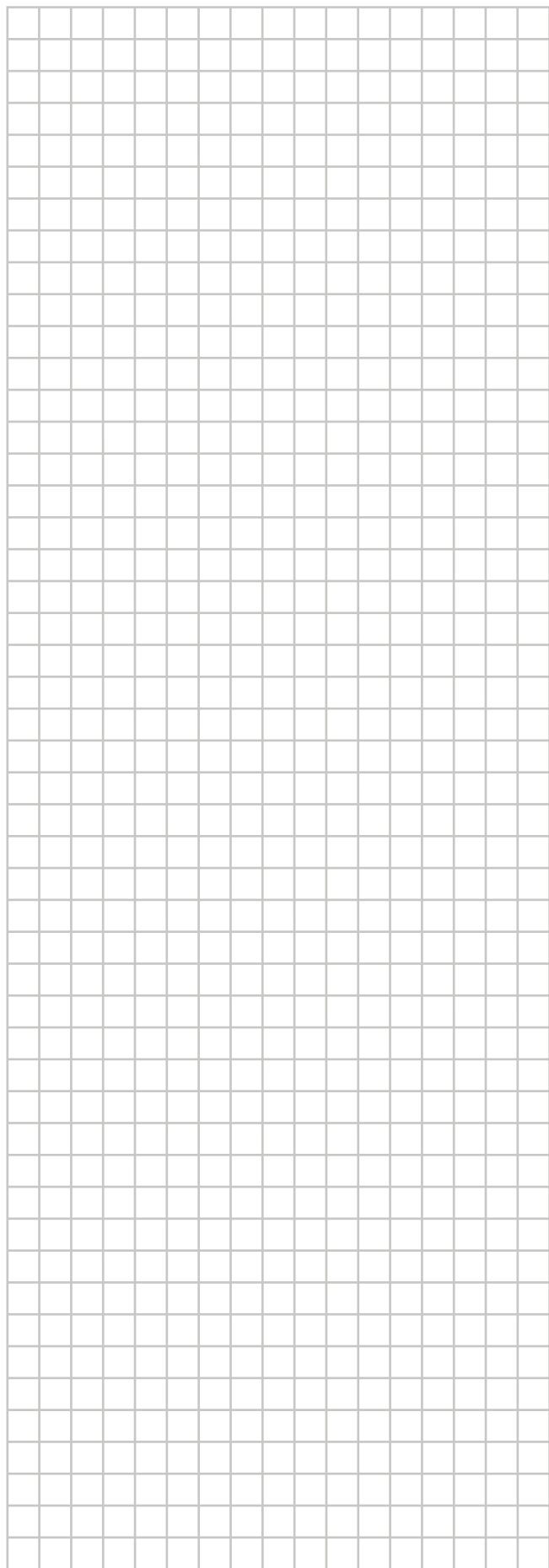
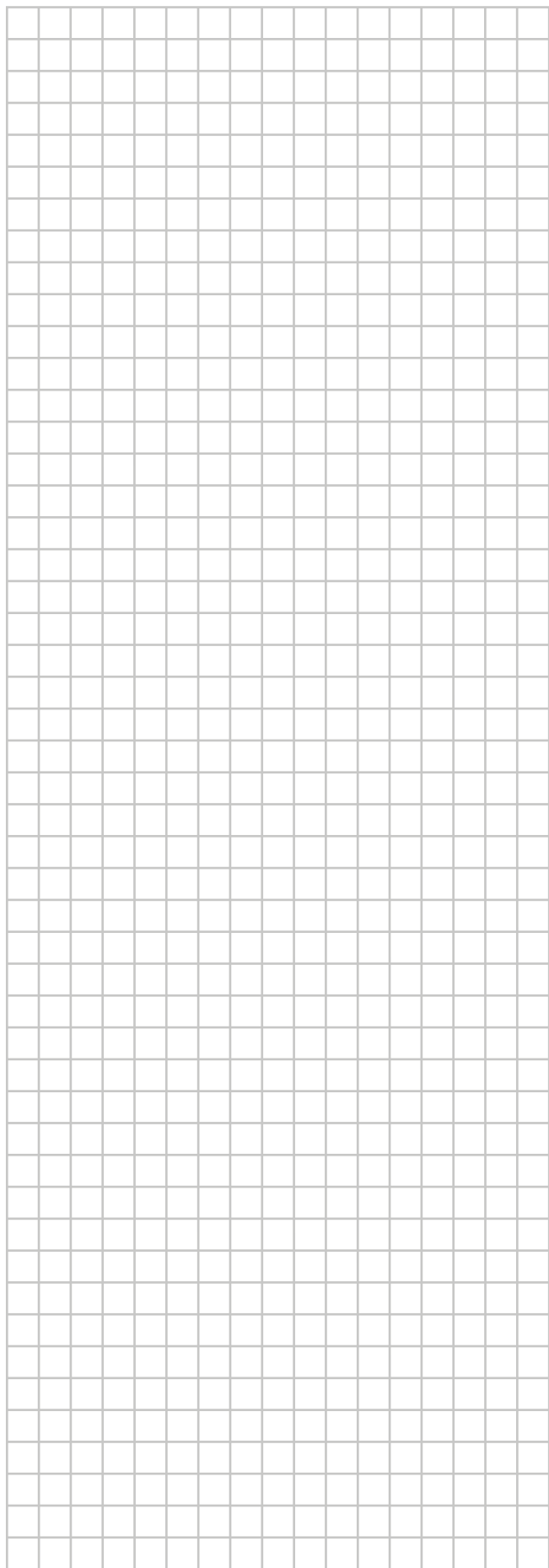

ERC



4P569811-1 0000000S

Copyright 2019 Daikin

DAIKIN EUROPE N.V.

Zandvoordestraat 300, B-8400 Oostende, Belgium

4P569811-1 2019.02